

DIV. NORTHERN
SUB. DIV. AFTON
STP. No. L-111

ERECTED. 1870.
TYPE. FRAME.
FOUNDATION. PILE HEADS.
WALLS. 2x6 STUDS.
ROOF { TYPE. GABLE SHINGLE.
PITCH. APPROX. 1/3.
HEATING. STOVES.

FLOOR. 7/8" x 3 1/4"
FINISH { INSIDE. 1/8" x 5/16" M.E.B.
OUTSIDE. 1x12 BOARD & BATT.
CEILING HEIGHT. 11'-4"
LIGHTING. LAMPS.
SANITARY FACILITIES OUTSIDE TOILETS.

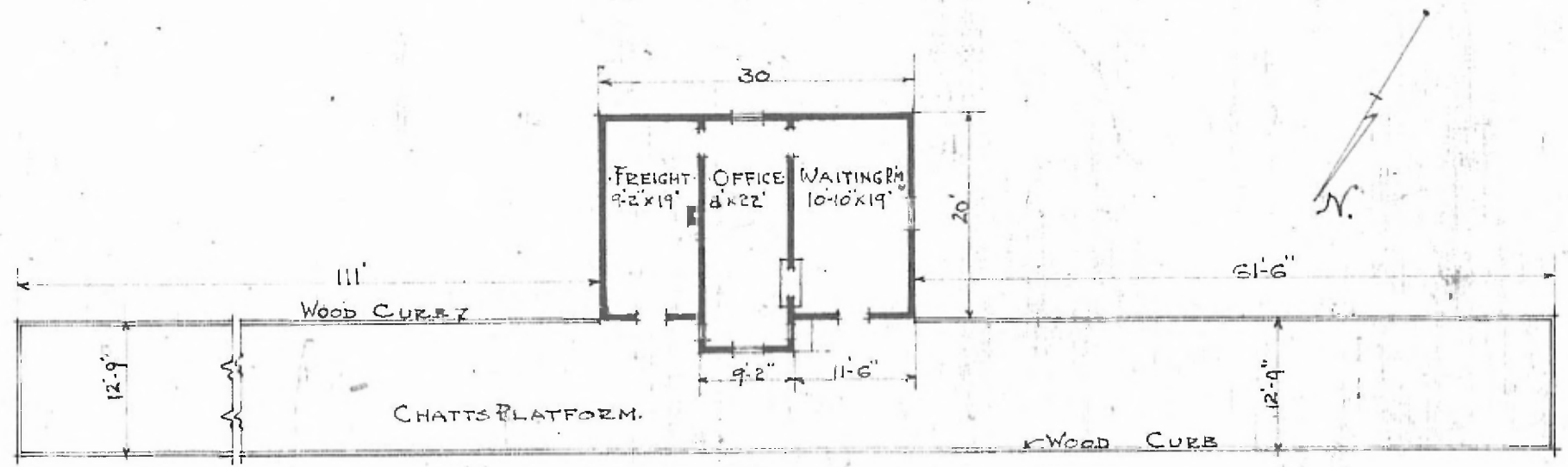

FLOOR PLAN.
SCALE 1/16" = 1'-0".

COMBINATION STATION.
ANNA, KAN.

JUNE 8 - 1915.