

DIV. NORTHWEST AFTON  
 SUB. DIV. BURTON (39)

ERECTED: 1906  
 TYPE: FRAME  
 FOUNDATION: CONCRETE  
 WALLS: 2"x6" STUDS  
 ROOF: TYPE: GABLE SHINGLES.  
 PITCH: APPROX. PITCH 1/3  
 HEATING: STOVES

FLOOR: 3/4"x3 1/2" PINE  
 FINISH: { INSIDE: 3/4"x3 1/2" BD. CEILING.  
 OUTSIDE: BOARDS & BATTS  
 CEILING HEIGHT: 11'-5"  
 LIGHTING: LAMPS  
 SANITARY FACILITIES: OUTSIDE TOILETS

STATION F-547  
 L 130

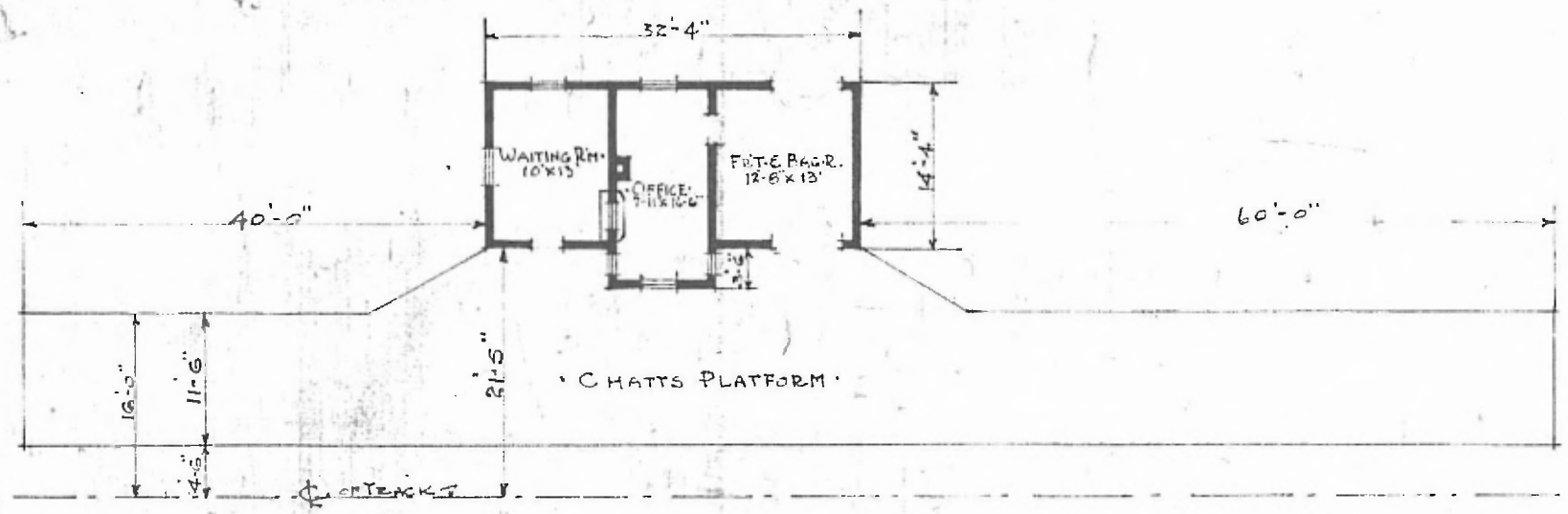

FLOOR PLAN  
 SCALE: 1/16" = 1'-0"

COMBINATION STATION  
 BEULAH, KANS.

MAY 9-1917.