

ERECTED. 1902.
 TYPE. FRAME.
 FOUNDATION. PILE HEADS.
 WALLS 2x6"
 ROOF { TYPE. SHINGLES.
 [PITCH. 1/4.
 HEATING. STOVES.

FLOOR. 7/8 x 3/4"
 FINISH { INSIDE 7/8 x 3/4" W. PINE.
 [OUTSIDE 1x12" BOARD & BATTS.
 CEILING HEIGHT. 10'-7"
 LIGHTING. LAMPS.
 SANITARY FACILITIES OUTSIDE TOILET.

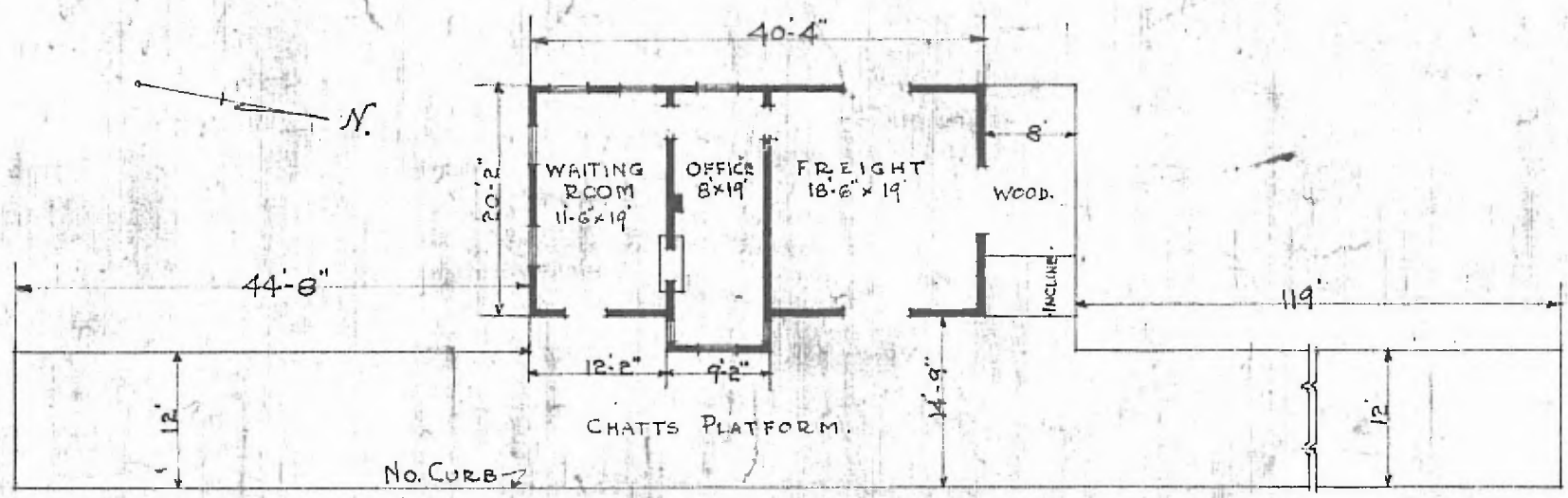

FLOOR PLAN.
 SCALE 1/16" = 1'-0".

JUNE 24 1915.

COMBINATION STATION AT
 BOICOURT. KANS.