

ERECTED 1896
 TYPE FRAME
 FOUNDATION PILE HEADS
 WALLS 2"x6"
 ROOF { TYPE GABLE-SHINGLES
 PITCH- 1/3
 HEATING STOVES

FLOOR FINISH { INSIDE
 OUTSIDE
 CEILING HEIGHT
 LIGHTING
 SANITARY FACILITIES- OUTSIDE TOILETS.

DIV. NORTHERN
 SUB-DIV. CARTHAGE
 7/8" x 3/4" M. & B. CEILING STR. NO. H 340
 1"x12" BOARDS & BATTENS.
 12'-2" FREIGHT ROOM- 9'-6"
 ELECTRIC- DROP CORD.

901

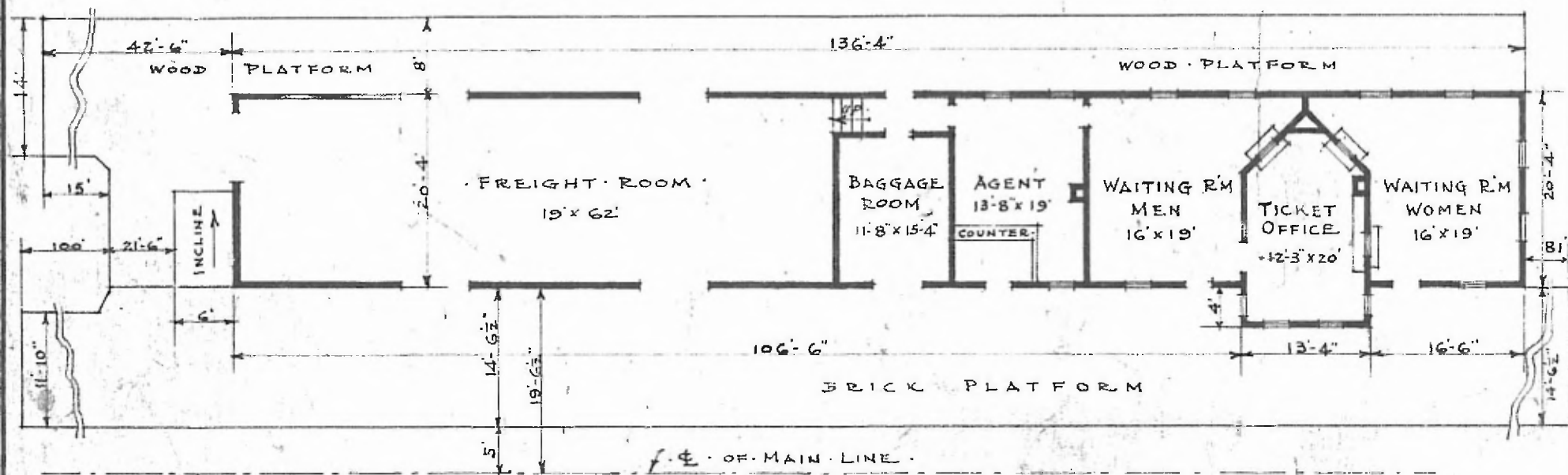

FLOOR PLAN
 SCALE: 1/16" = 1'-0"

PASSENGER STATION AT
 GALENA KAN.

AUGUST 6 1915