

ERECTED 1877
 TYPE FRAME
 FOUNDATION PILE HEADS.
 WALLS 2" x 6"
 ROOF { TYPE - GABLE - SHINGLES.
 PITCH - 1/3
 HEATING STOVES.

FLOOR 7/8" x 3 1/4"
 FINISH { INSIDE - 7/8" x 3 1/4" M. & B. W. PINE STAIN NO. F-352
 OUTSIDE - 1" x 12" BOARDS & BATTENS.
 CEILING HEIGHT 12'-7"
 LIGHTING OIL LAMPS.
 SANITARY FACILITIES - OUTSIDE TOILET.

DIV. NORTHERN
 SUB DIV. CARTHAGE

81

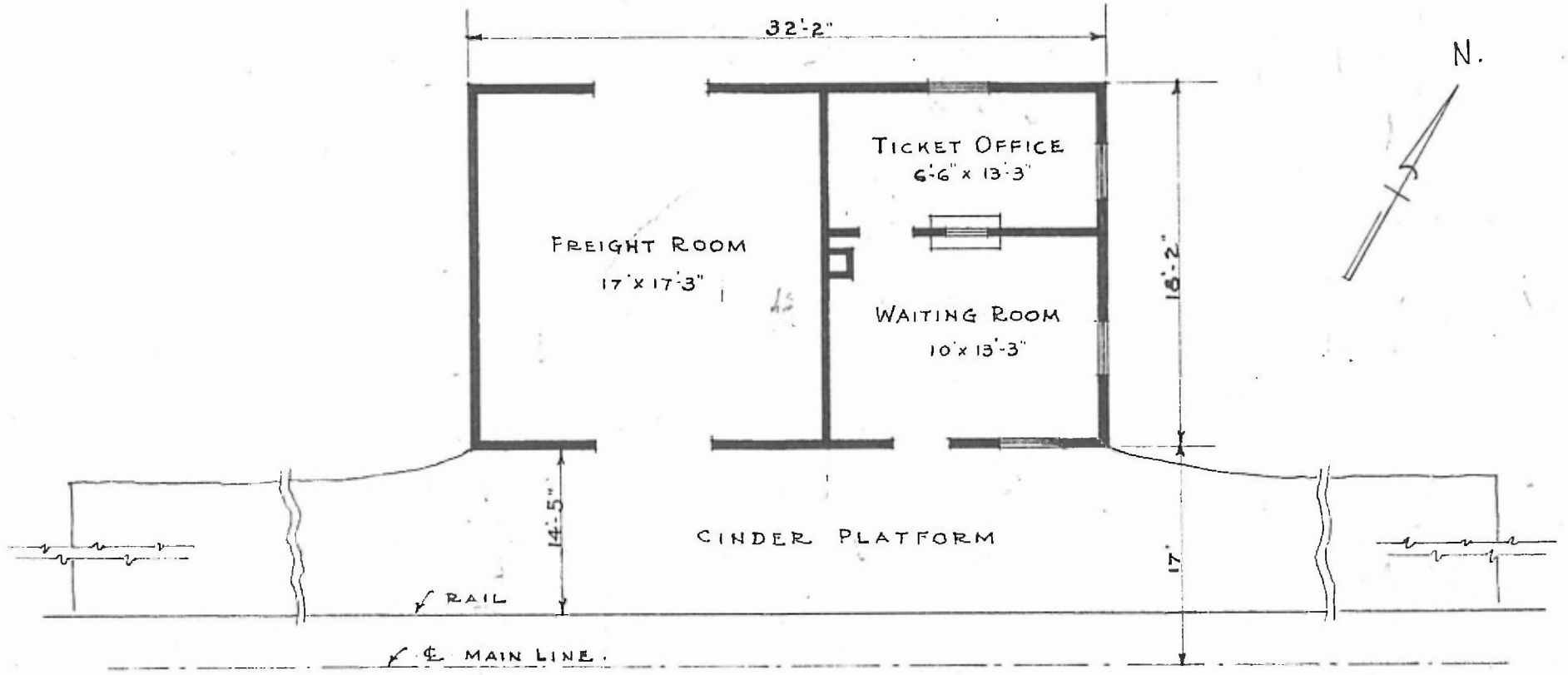

FLOOR PLAN.
 SCALE: 1/8" = 1'-0"

PASSENGER STATION AT
 HALLOWELL KANS.