

4

DIV. NORTHERN
SOB. DIV. KANSAS CITY
STA. NO. C-8

ERECTED: 1889
 TYPE: FRAME
 FOUNDATION: PILE HEADS
 WALLS: 2" x 6"
 ROOF TYPE: GABLE SHINGLE
 PITCH: 1/3
 HEATING: STOVES

FLOOR: 7/8" x 3 1/4"
 FINISH: INSIDE: 7/8" x 5 1/4" WP. M & B.
 CEILING: PLASTER
 OUTSIDE: 6" LAP SIDING
 CEILING HEIGHT: 14' 4"
 LIGHTING: LAMPS
 SANITARY FACILITIES: OUTSIDE TOILETS

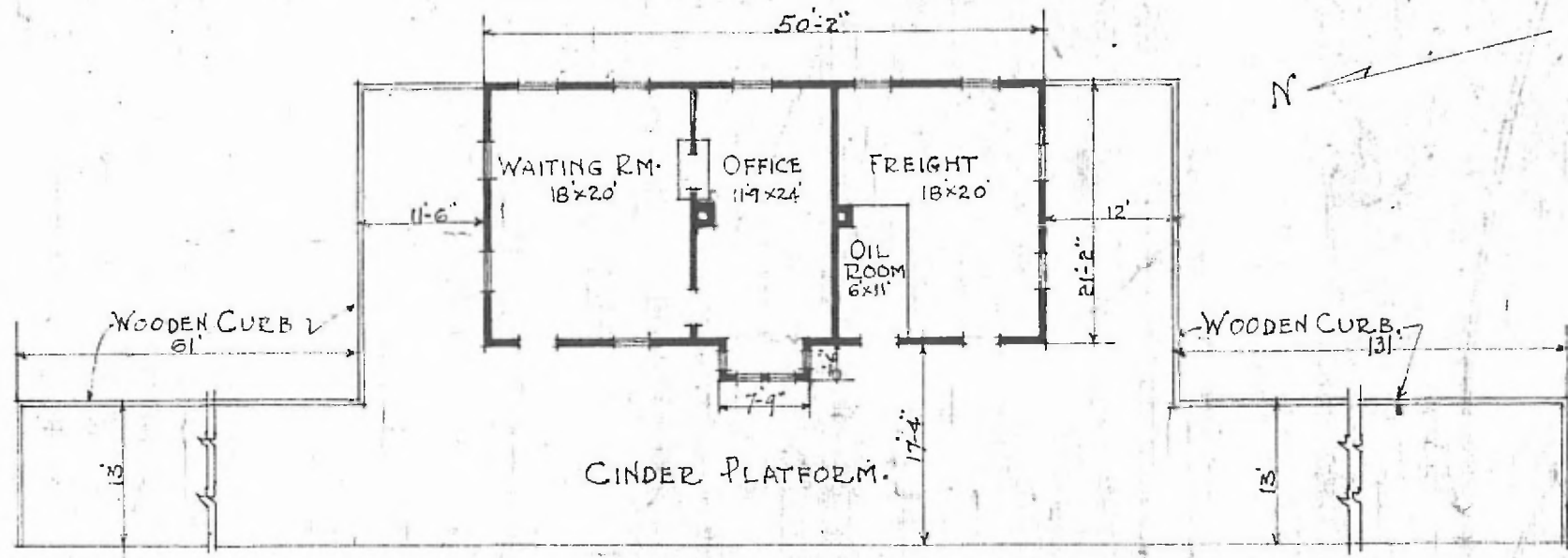

FLOOR PLAN
 SCALE 1/16" = 1'-0"

COMBINATION STATION AT
 MERRIAM, KANS.

JULY 5, 1915.