

ERECTED 1899.
 TYPE FRAME
 FOUNDATION PILE HEADS
 WALLS 2" x 6"
 ROOF { TYPE - GABLE - SHINGLES.
 PITCH - 1/3
 HEATING GAS STOVES

FLOOR FINISH { INSIDE
 OUTSIDE
 CEILING HEIGHT 12'-0" - FREIGHT ROOM = 9'-8"
 LIGHTING GAS
 SANITARY FACILITIES - INSIDE TOILETS.

7/8" x 3/4" Y. P.
 7/8" M. E. B. CEILING.
 1" x 12" WITH BATTENS - SHINGLES & 7/8" DROP SIDING.

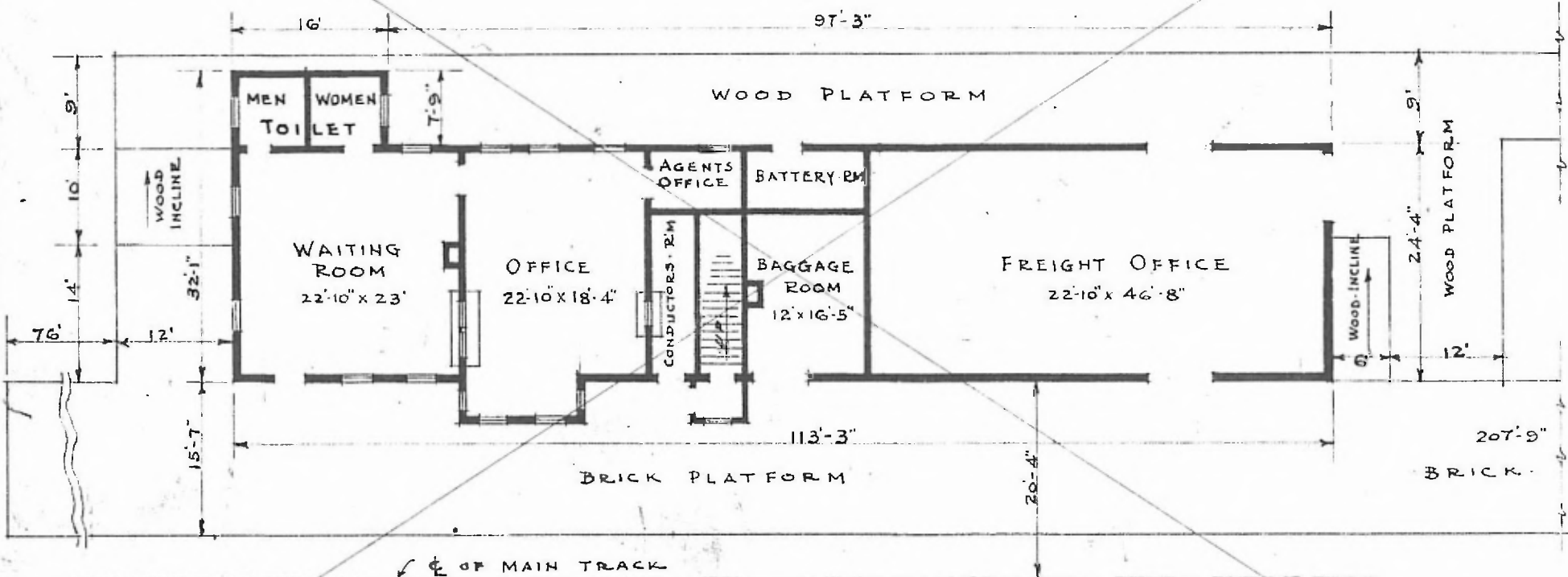

DESTROYED BY FIRE 9-24-18

• FIRST FLOOR PLAN •

• SCALE: 1/16" = 1'-0" •

• PASSENGER STATION AT
 • NEODESHA, KAN. •