

ERECTED 1879
 TYPE FRAME
 FOUNDATION PILE HEADS
 WALLS 2" x 6"
 ROOF TYPE: GABLE, SHINGLES
 PITCH: 9
 HEATING STOVES

FLOOR 3/4" x 3 1/4" Y.P.
 FINISH { INSIDE: 3/4" x 5 1/4" M. & B.
 OUTSIDE: BOARDS & BATTENS
 CEILING HEIGHT 10'-6"
 LIGHTING GAS LAMPS
 SANITARY FACILITIES OUTSIDE TOILET.

DIV. IV. NORTHERN
 SUB. DIV. WICHITA
 STA. NO. F-420

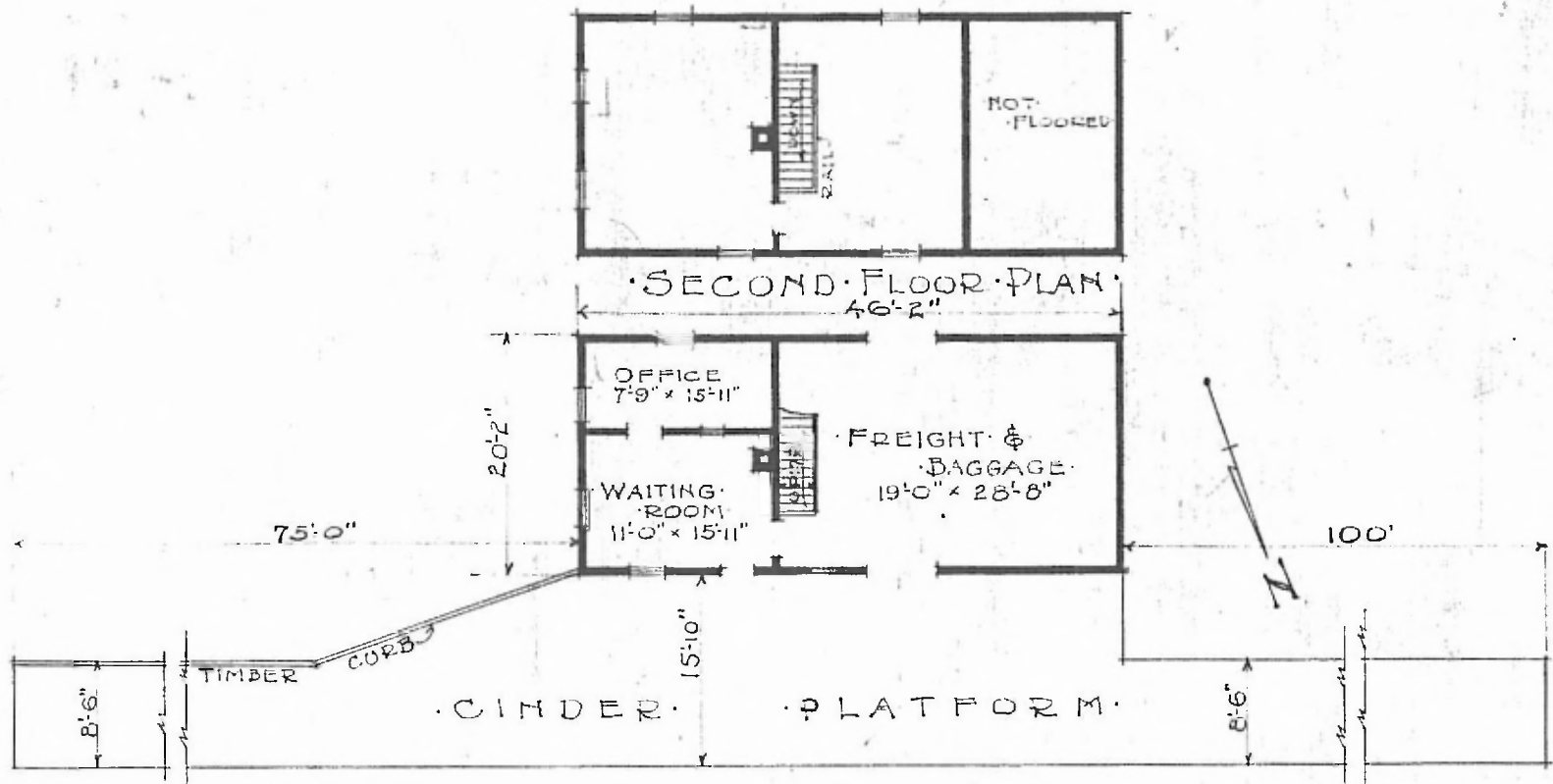

FIRST FLOOR PLAN
 SCALE 1/16" = 1'-0"

COMBINATION STATION
 NEW ALBANY KANS.

APRIL 6, 1917.