

90

ERECTED 1877
 TYPE FRAME
 FOUNDATION PILE HEADS
 WALLS 2" x 4"
 ROOF { TYPE - GABLE - SHINGLES.
 PITCH - 1/3
 HEATING GAS STOVES

FLOOR 7/8" x 3/4"
 FINISH { INSIDE 7/8" x 5 1/4" WH. PINE - 5' WAINSCOT.
 OUTSIDE 1" x 12" BOARDS & BATTIS - 7/8" x 5 1/4" DROP SIDING.
 CEILING HEIGHT 12'3" - OFFICE = 9'8" - FR.T. ROOM = 14'8"
 LIGHTING ELECTRIC & GAS.
 SANITARY FACILITIES - INSIDE TOILETS.

DIV. NORTHERN
 SUB. DIV. CARTRIDGE
 STA. NO. F-360

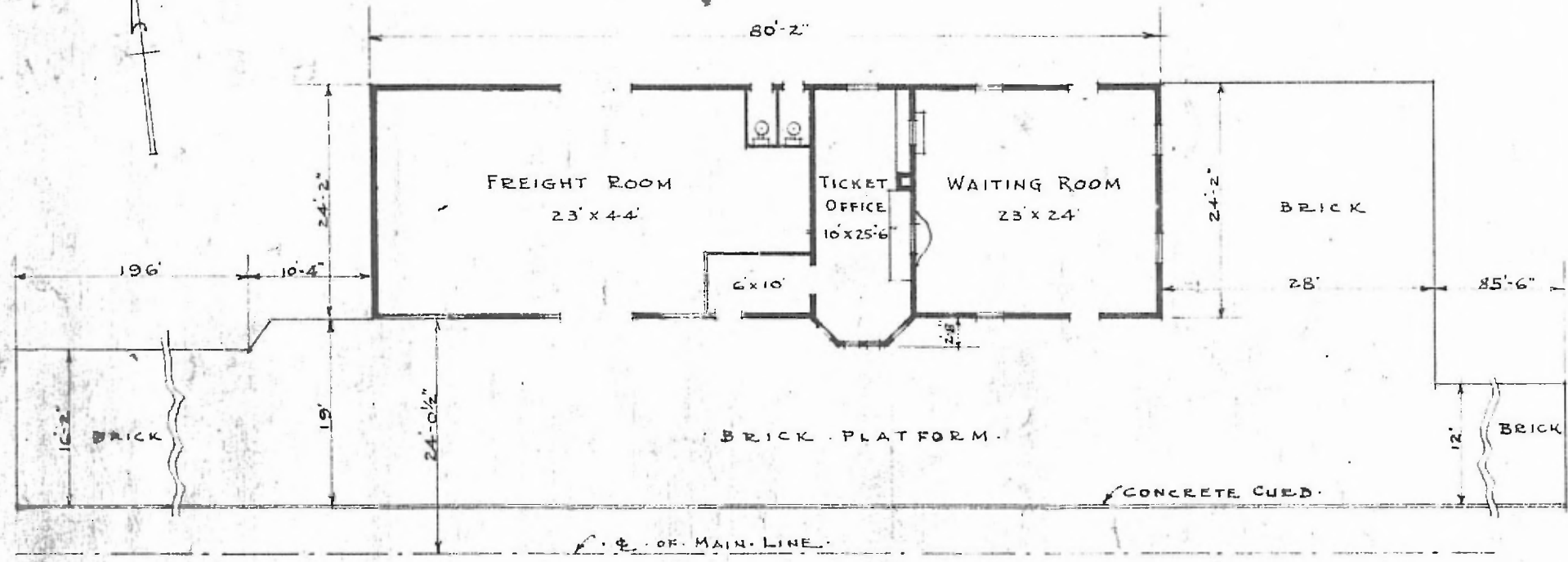

FLOOR PLAN
 SCALE: 1/16" = 1'-0"

PASSENGER STATION AT
 OSWEGO KAN.

JULY 7 1915