

ERECTED. 1928.
 TYPE. BRICK.
 FOUNDATIONS. CONCRETE.
 WALLS. BRICK 13"
 ROOF. { TYPE. TILE.
 HEATING. 1/4 APPROX.
 GAS. STEAM

FLOOR.
 FINISH. { INSIDE
 OUTSIDE.
 CEILING HEIGHT.
 LIGHTING.
 SANITARY FACILITIES.

{ WTG. RMS. & TOILETS. COMPOSITION.
 TICKET OFFICE. WOOD. BAGG. RM. CEMENT.
 PLASTER & BRICK.
 BRICK.
 WTG. RM. 11'-3" BAGG. RM. 12'-11 1/4"
 ELECTRIC.
 INSIDE TOILETS

DIV. NORTHERN
 SUB. DIV. PARSONS
 STA. NO. M-137

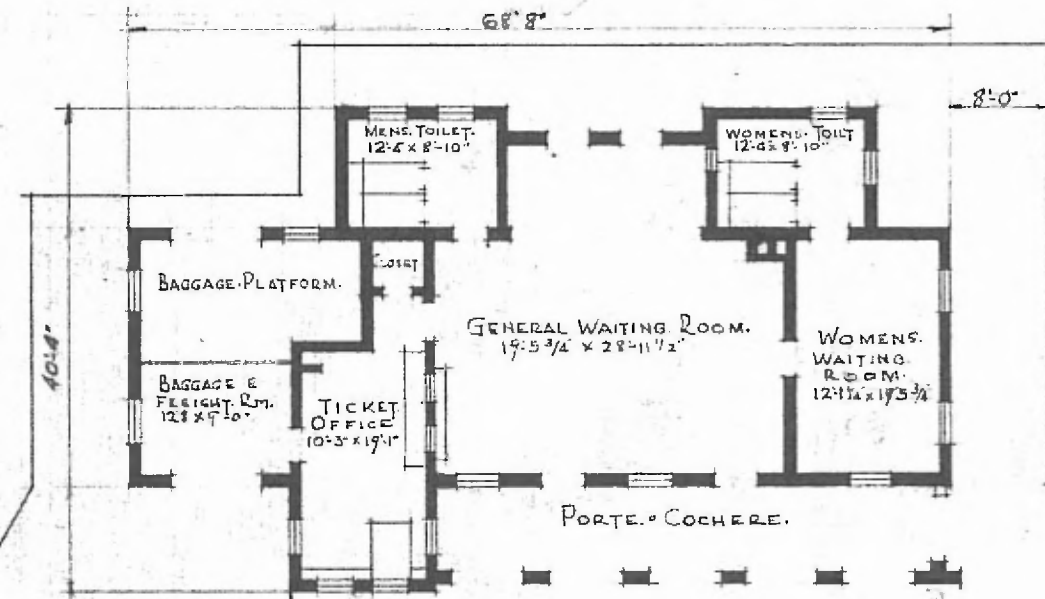

BRICK PLATFORM.
 46' LONG. & 16' WIDE.

CONC. & BRICK CURB

MAIN TRACKS PASSENGER STATION.

PITTSBURG KANS.