

110

- ERECTED: 1887
- TYPE: FRAME
- FOUNDATION: PILE HEADS
- WALLS: 2"x6"
- ROOF: TYPE GABLE SHINGLES
PITCH: 3
- HEATING: STOVES

- FLOOR: 3/4" x 3/4" Y.P.
- FINISH: (INSIDE: 3/4" x 3/4" M. & B.
OUTSIDE: BOARDS & BATTENS)
- CEILING HEIGHT: 15'-3"
- LIGHTING: OIL LAMPS
- SANITARY FACILITIES: OUTSIDE TOILETS

DIV. NORTHERN
SUIB. DIV. BURTON
STR. No. F-584

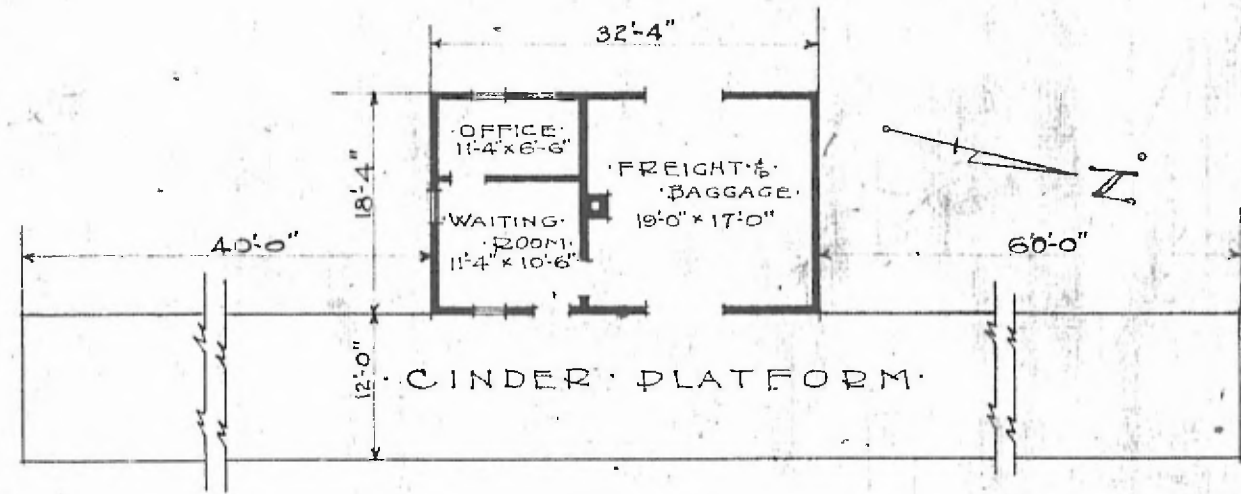

FLOOR PLAN
SCALE 1/16" = 1'-0"

COMBINATION STATION
POLLARD KANS.

APRIL 21, 1917