

ERECTED 1909.  
 TYPE FRAME  
 FOUNDATION CONCRETE  
 WALLS 2" x 4"  
 ROOF { TYPE - HIP - SHINGLES.  
 PITCH - 1/3  
 HEATING STOVES.

FLOOR 7/8" x 5 1/4"  
 FINISH { INSIDE 7/8" x 3 1/4" M. & B.  
 OUTSIDE 1 x 12 BOARDS & BATTIS - 7/8" x 5 1/4" DROP SIDING.  
 CEILING HEIGHT 11' 3"  
 LIGHTING OIL LAMPS.  
 SANITARY FACILITIES - OUTSIDE TOILETS.

DIV. NORTHEN  
 SUB. DIV. CARTRIDGE  
 STA. NO. H-344

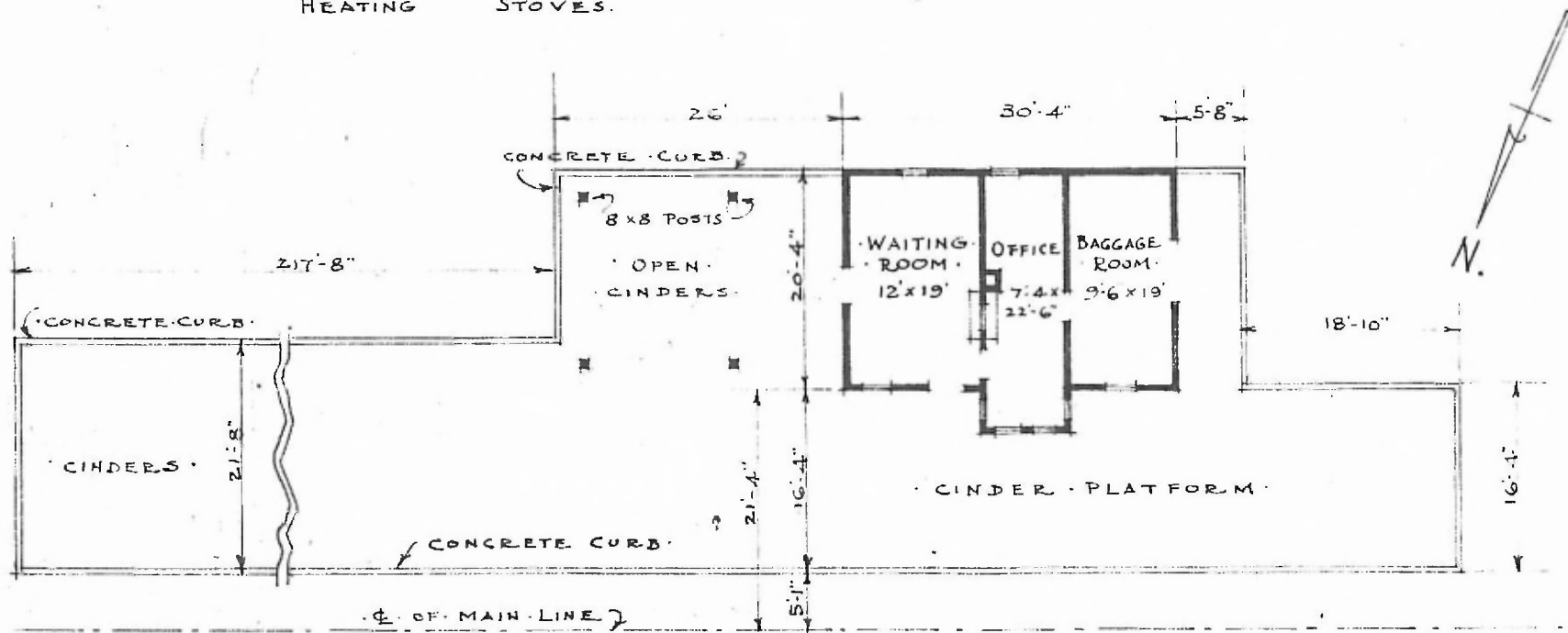

FLOOR PLAN.  
 SCALE: 1/16" = 1'-0".

PASSENGER STATION AT  
 RIVERTON. MO. KS

MAY 20 1915