

·ERECTED· 1887
 ·TYPE· FRAME·
 ·FOUNDATION· PILE HEADS
 ·WALLS· 2"×6"
 ·ROOF· {TYPE: GABLE, SHINGLES
 PITCH: 1/3
 ·HEATING· STOVES

·FLOOR· 3/4"×3 1/4" Y.P.
 ·FINISH· {INSIDE: 3/4"×3 1/4" M. & B.
 OUTSIDE: 1"×8" DROP SIDING
 ·CEILING HEIGHT· 15'3"
 ·LIGHTING· OIL LAMPS
 ·SANITARY FACILITIES· OUTSIDE TOILETS

DIV. NORTHERN
 SUBDIV. BURTON
 STA. No. F-565

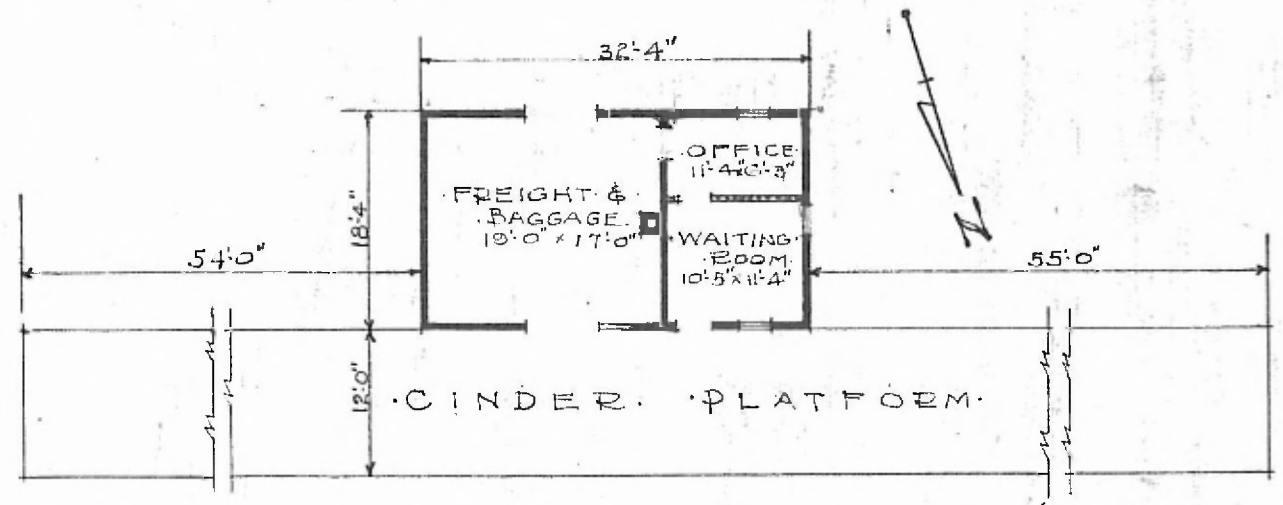

·FLOOR PLAN·
 SCALE 1/16" = 1'0"

·COMBINATION STATION·
 ·WHEBBY, KANS·

APRIL 20, 1917.