

ERECTED. 1889.
 TYPE. FRAME.
 FOUNDATION. PILE HEADS.
 WALLS. 2x6"
 ROOF. { TYPE. GABLE SHINGLE
 DITCH 1/8"
 HEATING. STOVES.

FLOOR. FINISH { INSIDE
 OUTSIDE. 7/8 x 3 1/4"
 BOXING & BATTENS.
 CEILING HEIGHTS. W. RM. 10'11" - FROG. RM. 12'6" OPEN.
 LIGHTING. LAMPS.
 SANITARY FACILITIES. OUTSIDE TOILETS.

SUB. DIV. TUPELO
 STATION C 574

59

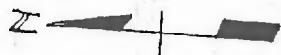
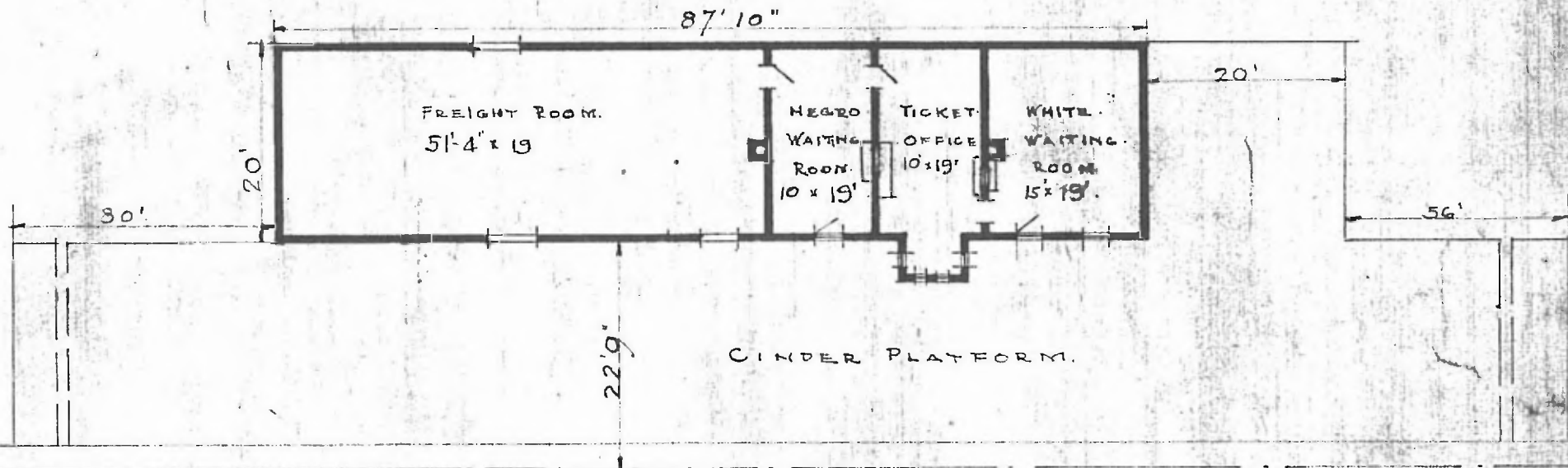

FLOOR PLAN
 SCALE 1/16" = 1'0"

COMBINATION STATION AT
 BLUE SPRINGS MISS.

FEB. 22 1913.