

SUB DIV. TOPEKA
STP. NO. C 562

ERECTED.
TYPE. BRICK.
FOUNDATION. CONCRETE.
WALLS. 13" BRICK.
ROOF {TYPE. TILE GABLE.
PITCH. 1/3.
HEATING. STOVES

FLOOR. 3/8 x 2 1/4 MAPLE FLOOR.
FINISH. {INSIDE. PLASTER.
OUTSIDE. BRICK.
CEILING HEIGHTS. WA. RM. 12'6" - TRK 0. 12'6".
LIGHTING. LAMPS.
SANITARY FACILITIES. INSIDE TOILETS.

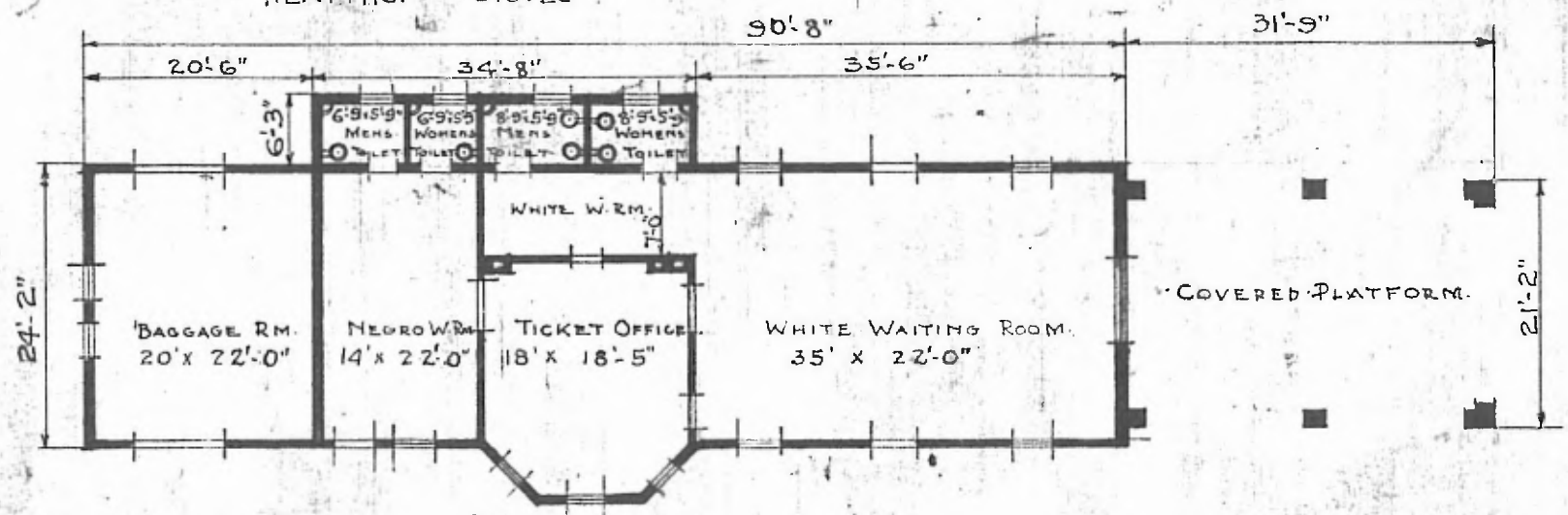

FLOOR PLAN
SCALE 1/4" = 10'

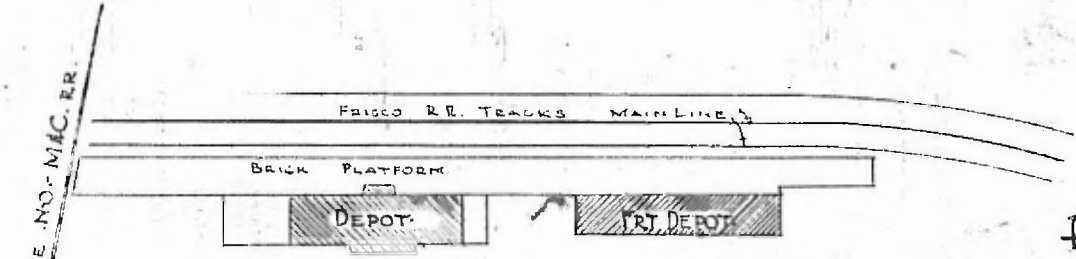

PLOT PLAN
SCALE: 1" = 100'

PASSENGER STATION AT
NEW ALBANY MISS.

JAN 9, 1918.