

ERECTED 1884  
 TYPE FRAME  
 FOUNDATION PILE HEADS  
 WALLS 2x6  
 ROOF { TYPE GABLE-SHINGLE  
 PITCH  $\frac{1}{3}$   
 HEATING STOVES

FLOOR

FINISH { INSIDE  
 OUTSIDE  
 CEILING HEIGHT  
 LIGHTING

SANITARY FACILITIES OUTSIDE TOILETS

SUB-DIV TUPALO  
 $\frac{3}{4} \times \frac{3}{4}$  Y.P. STR. No. C 597  
 $\frac{3}{4} \times \frac{3}{4}$  BEDED & V-JOINT CEILING  
 BOARDS & BATT.  
 10'-3"  
 OIL LAMPS

(65)

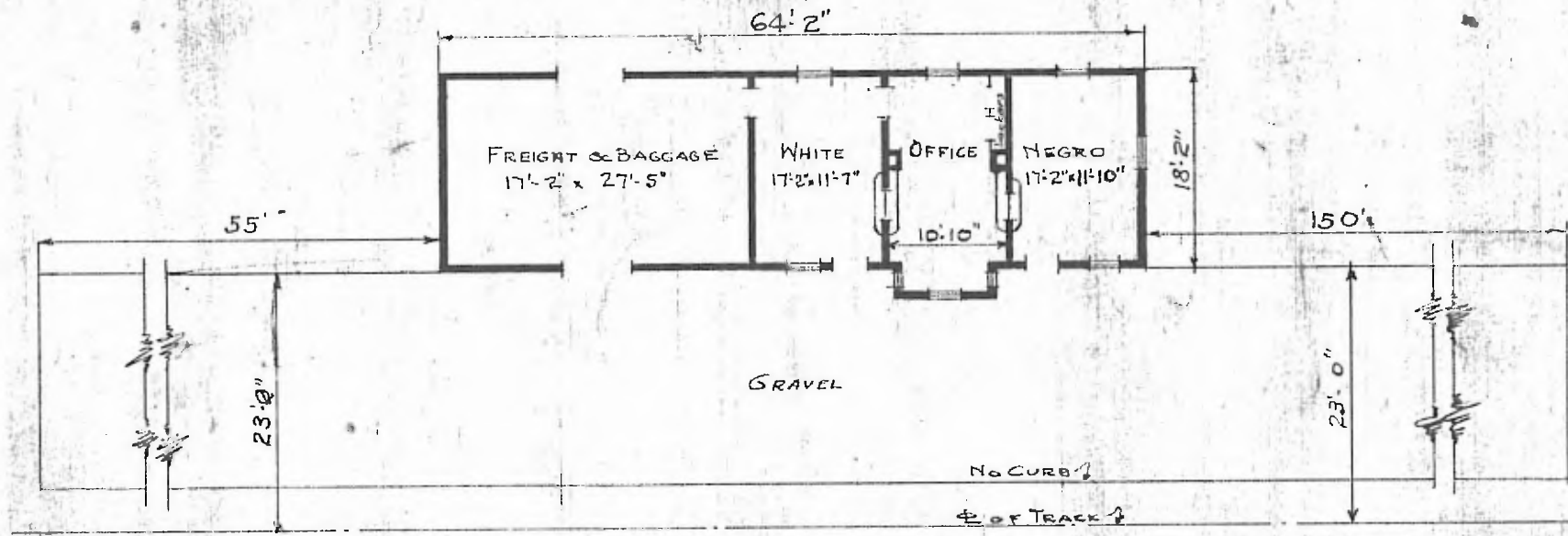

FLOOR PLAN  
 SCALE:  $\frac{1}{16}'' = 1'-0''$

COMBINATION STATION AT  
 PLANTERSVILLE MISS.