

DIV. SOUTHERN
SUB. DIV. TUPELO
STP. 176. C 535

- ERECTED: 1912.
- TYPE: FRAME.
- FOUNDATION: BLOCKS.
- WALLS: 2"x4"
- ROOF: {TYPE: SHINGLE GABLE.
PITCH: 1/4.
- HEATING: NONE.

- FLOOR: 2x8 V. PINE.
- FINISH: {INSIDE: OPEN.
OUTSIDE: DROPSIDING.
- CEILING HEIGHTS: WAITING RM. 9'
- LIGHTING: NONE.
- SANITARY FACILITIES: NONE.

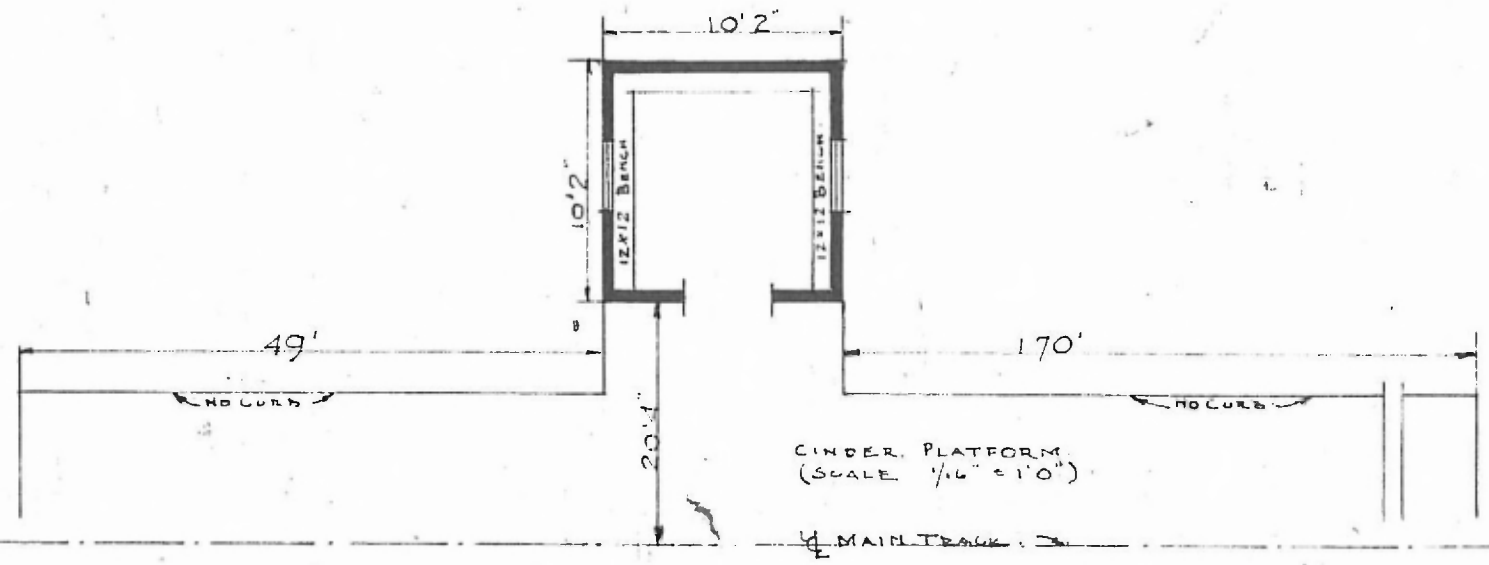

•FLOOR PLAN:
•SCALE: 1/8" = 1'0"

1 PASSENGER STATION
•WAITES MISS.



MAY 1, 1917