

74

ERECTED 1892
 TYPE STONE
 FOUNDATION RUBBLE-STONE
 WALLS STONE-BRICK BACKING
 ROOF { TYPE-HIP-SLATE
 PITCH-1/2 OR 45°
 HEATING STOVES.

FLOOR FINISH { INSIDE ·
 OUTSIDE ·
 CEILING HEIGHT 12'0" ·
 LIGHTING ELECTRIC ·
 SANITARY FACILITIES- INSIDE TOILETS ·

7/8" x 3/4" Y.P.
 PLASTER- & WOOD WAINSCOT- 4'6" HIGH ·
 STONE ·
 12'0" · BAGGAGE ROOM · 10'0"
 ELECTRIC ·
 INSIDE TOILETS ·

NORTHER DIV.
 CARTHAGE SUB
 ST. No. F. 313

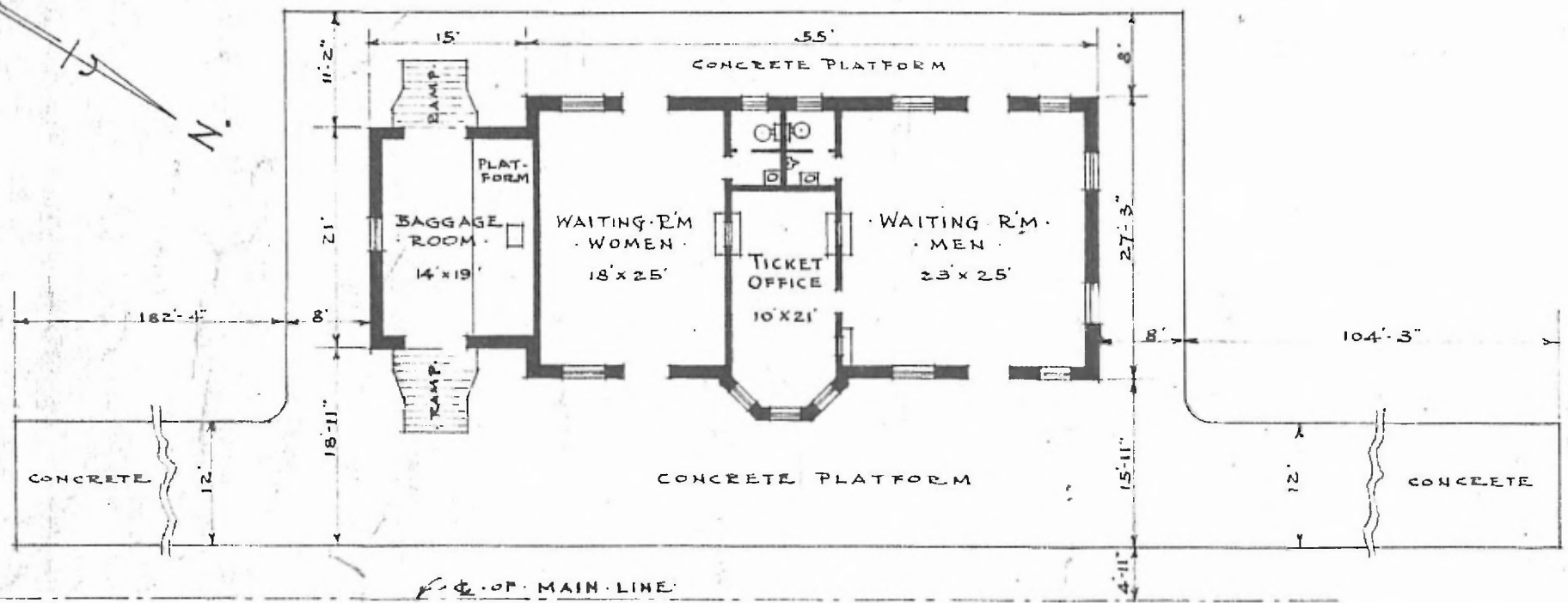

· PASSENGER · STATION · AT ·
 · CARTHAGE · MO ·

· FLOOR · PLAN ·
 · SCALE: 1/2" = 1'-0" ·

· MAY · 21 · 1915 ·