

ERECTED  
 TYPE FRAME  
 FOUNDATION WOOD BLOCKS  
 WALLS 2" x 6"  
 ROOF { TYPE - GABLE - SHINGLES  
       PITCH - 1/3  
 HEATING STOVES.

FLOOR  
 FINISH { INSIDE  
        { OUTSIDE  
 CEILING HEIGHT  
 LIGHTING  
 SANITARY FACILITIES -

3/4" x 3/4" Y. PINE  
 3/4" x 5/2" BD. CEILING.  
 BOARDS & BATTENS.  
 11'-1"  
 OIL LAMPS  
 OUTSIDE TOILETS.

EASTERN W.V.  
 SPRINGFIELD SUB  
 STA. No A-177

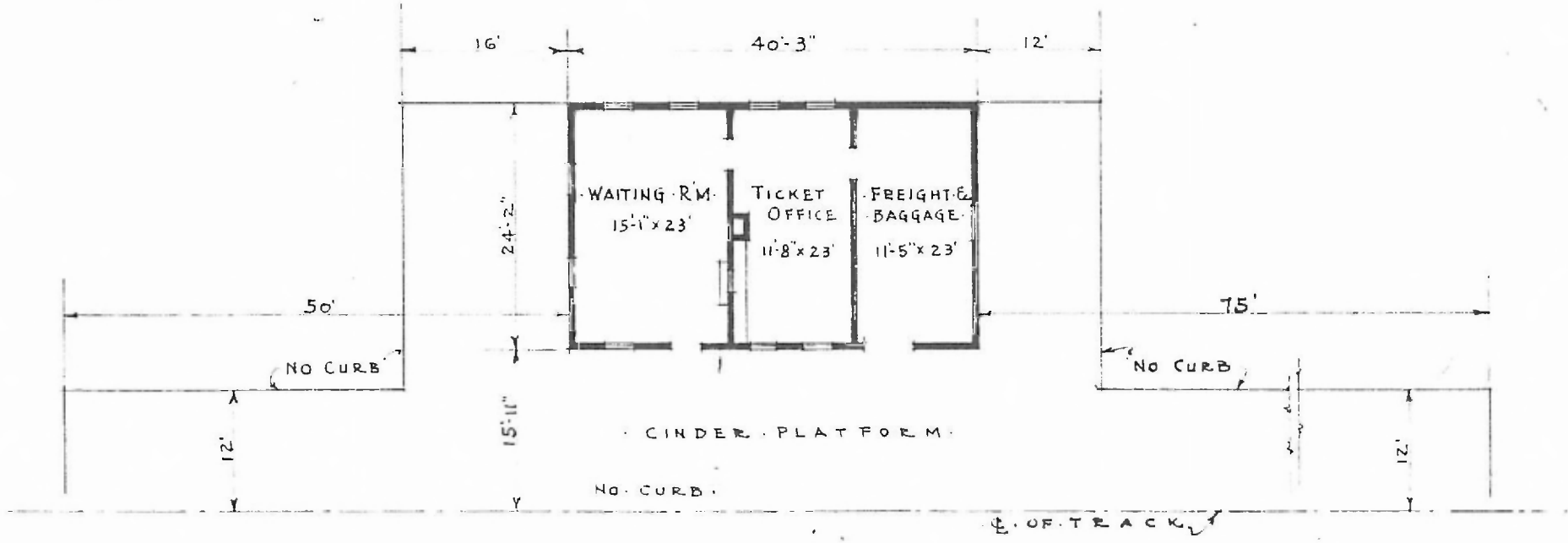

FLOOR PLAN  
 SCALE: 1/16" = 1'-0"

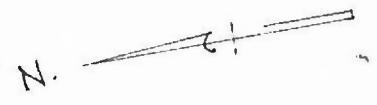

PASSENGER STATION AT  
 CHADWICK MO.