

ERECTED 1907
 TYPE BRICK
 FOUNDATION ?
 WALLS 13' BRICK
 ROOF { TYPE HIP-CLAY TILE - FRENCH PAT.
 PITCH $\frac{1}{4}$
 HEATING STOVES

FLOOR CONCRETE
 FINISH { INSIDE SAND PLASTER
 OUTSIDE MOTTLED BUFF BRICK
 CEILING HEIGHT 13'-0"
 LIGHTING ELECTRIC
 SANITARY FACILITIES INSIDE TOILETS

RIVER DIV.
 CHAFFEE SUB
 T 144 ST. P. 1/20

119

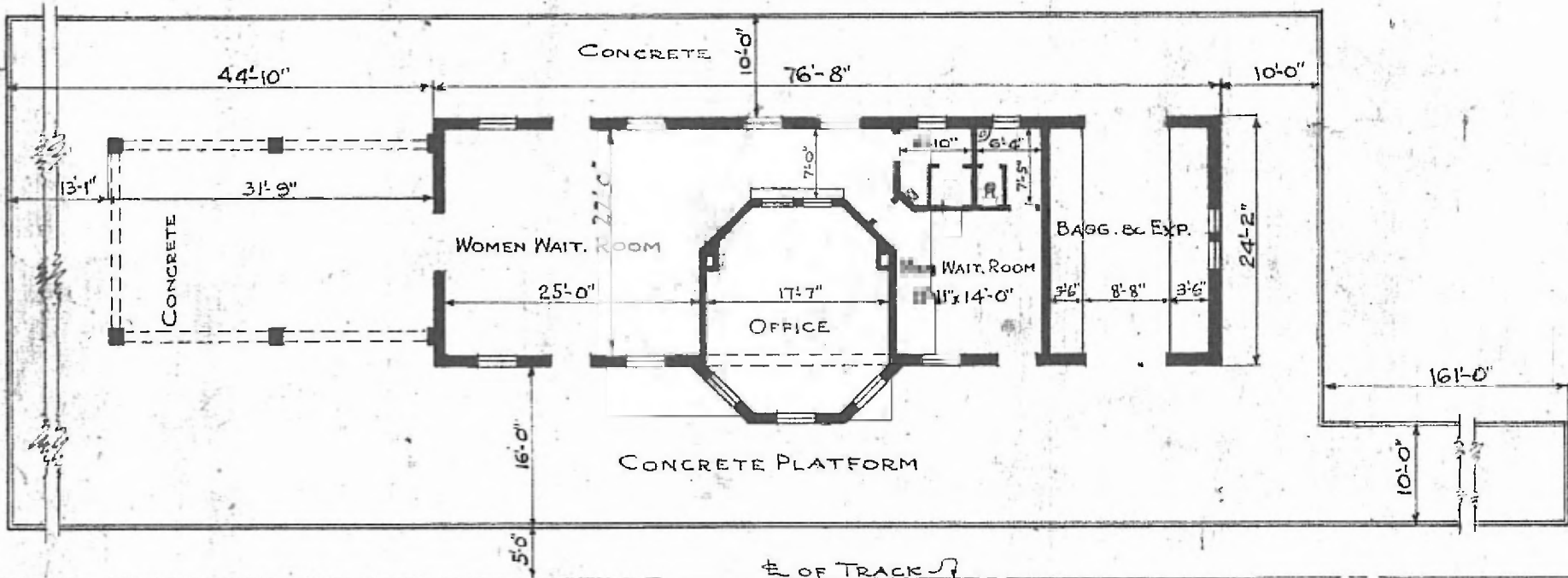

FLOOR PLAN
 SCALE: $\frac{1}{16}'' = 1'-0''$

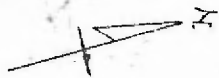

PASSENGER STATION
 CHAFFEE, MO.

OCT. 4, 1919