

8

ERECTED
TYPE
FOUNDATION
WALLS
ROOF { TYPE
PITCH
HEATING

FRAME
PILE HEADS
2x6
GABLE - SHINGLES
3
OTOVES

FLOOR
FINISH { INSIDE
OUTSIDE
CEILING HEIGHT
LIGHTING
SANITARY FACILITIES

$\frac{7}{8} \times 3\frac{1}{4}$ "
 $\frac{3}{4} \times 3\frac{1}{2}$ " M. & B.
BOXING & BATT. - $\frac{7}{8} \times 5\frac{1}{4}$ " DROP SIDING
WAITING RM. 11'-5" - FREIGHT RM. 10'-1"
ELECTRIC
OUTSIDE TOILETS

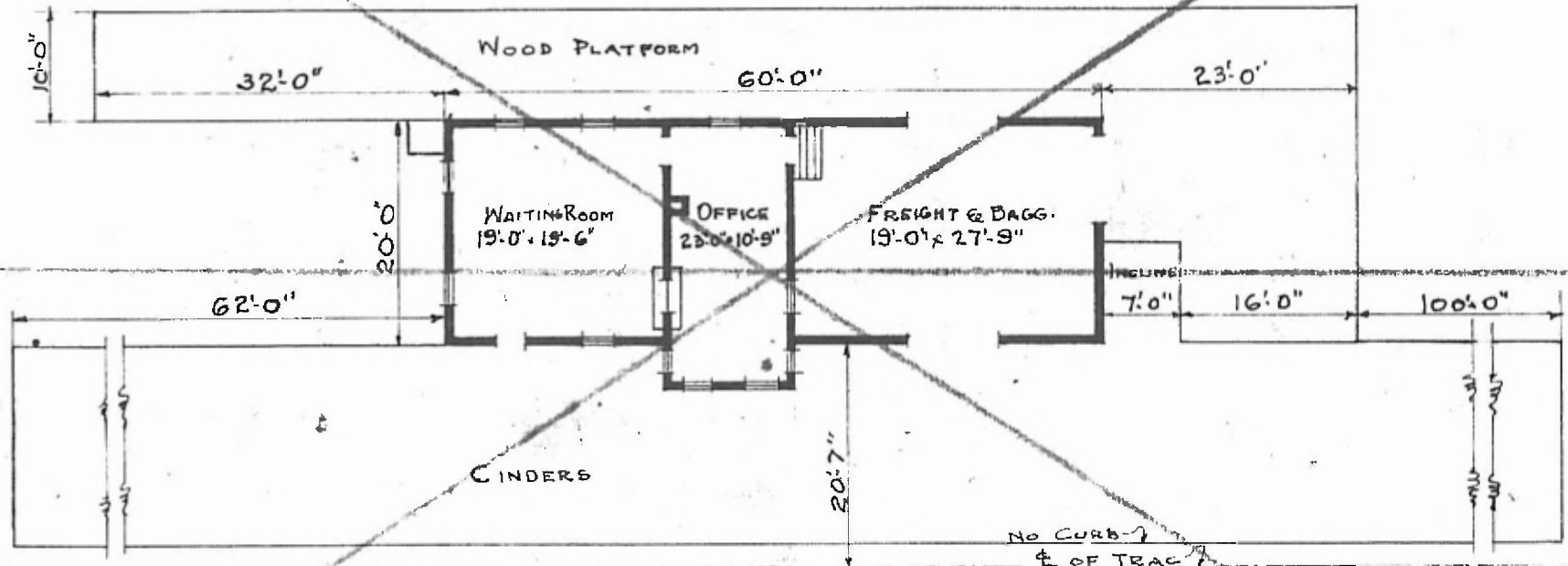

FLOOR PLAN
SCALE $\frac{1}{16} = 1'-0"$



COMBINATION STATION
CRYSTAL CITY, MO.

VOID - SEE NEW PLAN #8.

MARCH 8, 1918