

ERECTED 1914
 TYPE FRAME.
 FOUNDATION CONCRETE.
 WALLS 2"x6" STUDD.
 ROOF { TYPE HIP SHINGLE.
 PITCH 9 1/2" PER FOOT.
 HEATING STOVES.

FLOOR 7/8"x3 1/4" PINE.
 FINISH { INSIDE 7/8"x3 1/4" V. JOINT
 OUTSIDE DROP SIDING.
 CEILING HEIGHT 11'-3"
 LIGHTING LAMPS.
 SANITARY FACILITIES OUTSIDE.

EASTERN RAILROAD
 LE BAYON SUB
 STA. No. 129 (103)

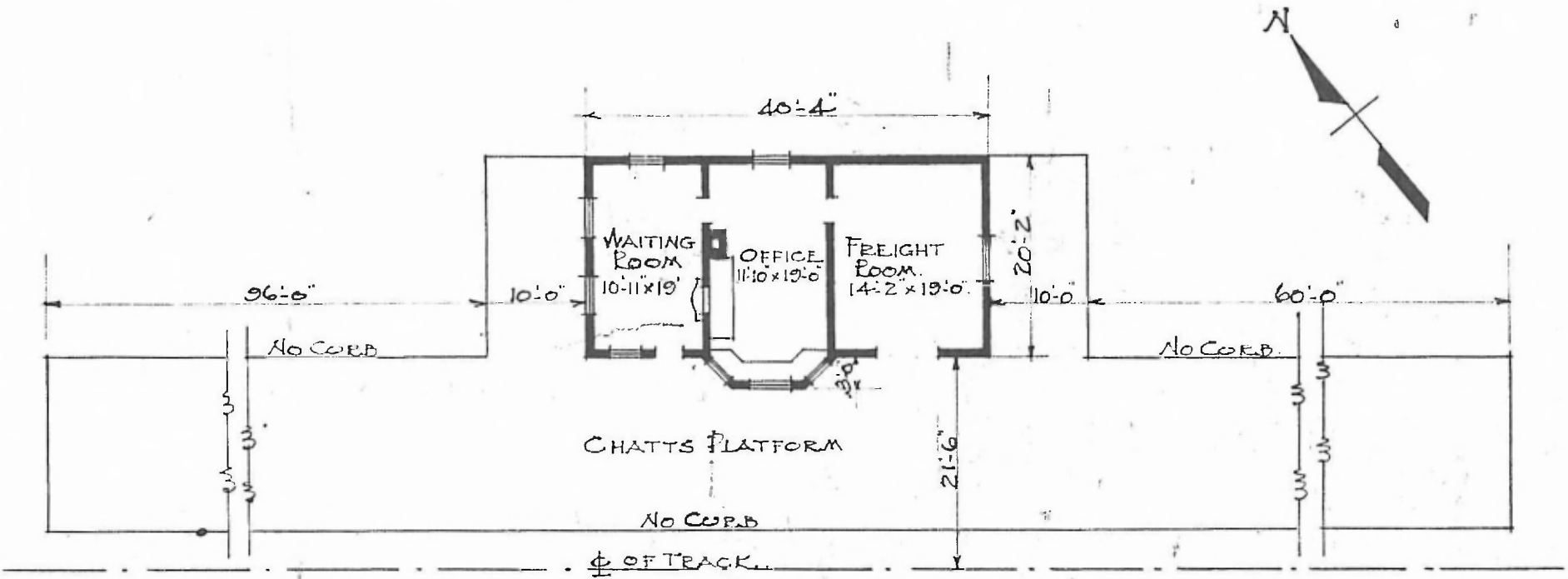

FLOOR PLAN.
 SCALE 1/16" = 1'-0"

PASSENGER STATION.
 FRANKS, MO.

JAN. 2. 1917.