

ERECTED 1885
 TYPE FRAME
 FOUNDATION PILE HEADS
 WALLS 2x6
 ROOF { TYPE GABLE-SHINGLES
 PITCH 1/3
 HEATING STOVES

FLOOR
 FINISH { INSIDE
 OUTSIDE
 CEILING HEIGHT
 LIGHTING
 SANITARY FACILITIES
 M&B.
 BOX. & BATT.
 WAIT. RM. = 12'-4" • BAGG. RM. = 12'-10"
 OIL
 OUTSIDE TOILETS

DIV. S. RIVER
 SUB. DIV. MOBILE
 STA. No. 5269

119

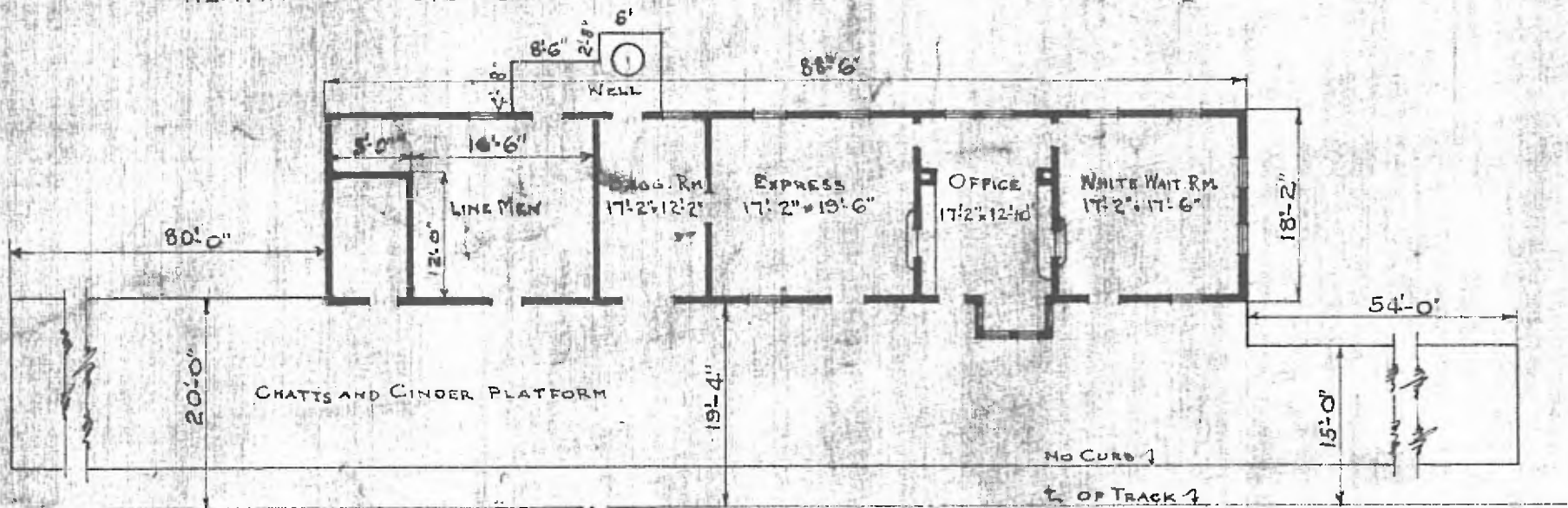

FLOOR PLAN
 Scale: 1/16" = 1'-0"



PASSENGER STATION
 HUNTER, MO.

Aug. 20, 1919