

ERECTED 1881
 TYPE FRAME
 FOUNDATION CON. PIERS
 WALLS 2" x 6"
 ROOF TYPE GABLE SHINGLES
 PITCH $\frac{1}{3}$
 HEATING STOVES

FLOOR 3/4" x 3/4" EDGE G. Y. P.
 FINISH INSIDE 3/4" x 3/4" M. & B.
 OUTSIDE 1" x 6" DROP SIDING
 CEILING HEIGHT 13' 2"
 LIGHTING ELECTRIC
 SANITARY FACILITIES INSIDE TOILETS

NORTHERN DIV
 ASH GRO V13 S13
 STA. No. C159

57

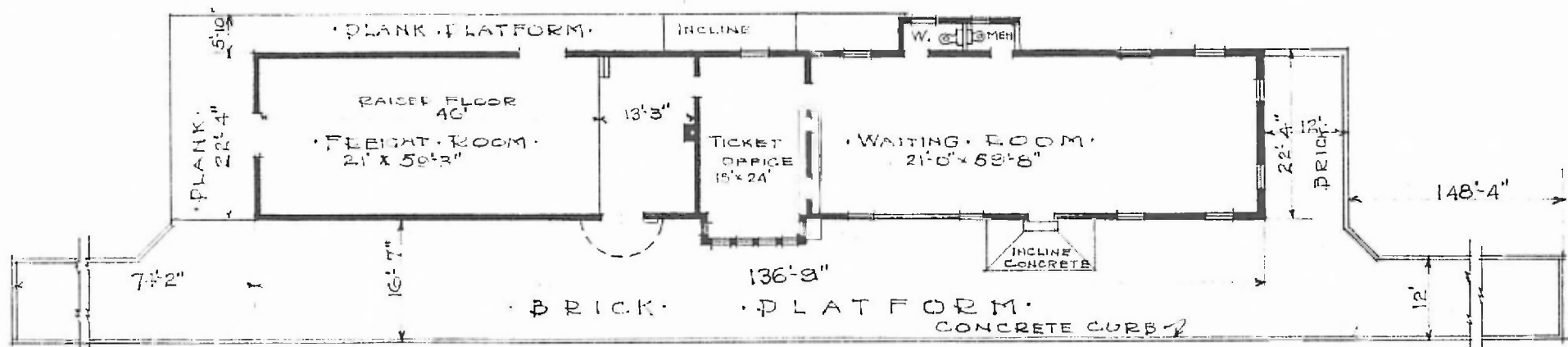

FLOOR PLAN
 SCALE 1/16" = 1'-0"

Nov. 10, 1915.

COMBINATION STATION
 LOCKWOOD MO.