

RIVER ST. LEITCHVILLE R.R. STP. NO. TK 217

ERECTED 1897  
 TYPE FRAME  
 FOUNDATION PILE HEADS  
 WALLS 2x6  
 ROOF { TYPE GABLE-SHINGLES  
 PITCH 1/4  
 HEATING STOVES

FLOOR 7/8 x 3/4  
 FINISH { INSIDE 7/8 x 3/4 M. & B. VERTICAL  
 OUTSIDE 7/8 x 5/2" DROP SIDING  
 CEILING HEIGHT WAIT. RM. = 11'-6" FRET ROOM = 9'-6"  
 LIGHTING ELECTRIC  
 SANITARY FACILITIES OUTSIDE TOILETS

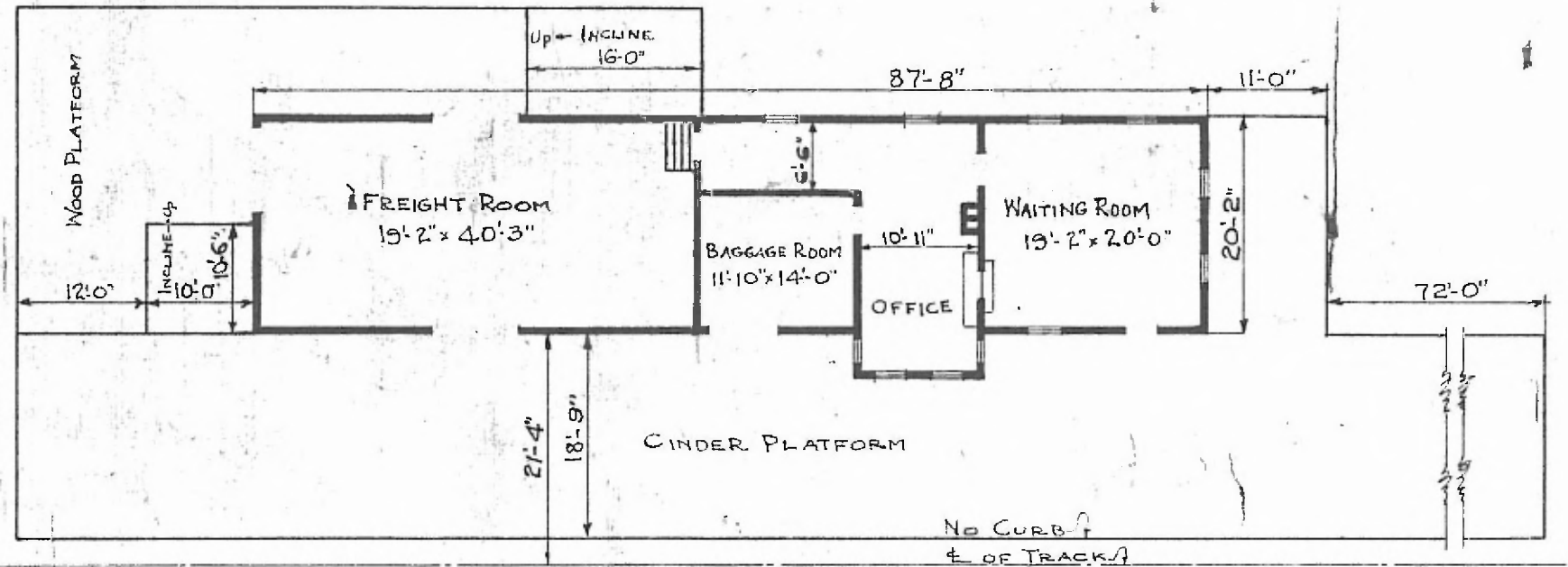

FLOOR PLAN  
 SCALE: 1/16" = 1'-0"

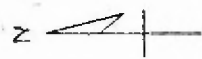

DESTROYED BY FIRE JAN. 4, 1920

COMBINATION STATION  
 MALDEN, MO.

OCT. 29, 1919