

26

ERECTED 1903
 TYPE FRAME
 FOUNDATION PILE HEADS
 WALLS 2x6
 ROOF { TYPE GABLE-READY ROOFING
 PITCH 1/3
 HEATING STOVES

FLOOR FINISH { INSIDE
 OUTSIDE
 CEILING HEIGHT
 LIGHTING
 SANITARY FACILITIES

3"
4x3 1/4" Y.P.
 3/4x3 1/4" BLEEDED CEILING
 B. & B. 1x6" DROP SIDING
 WAIT. RM. = 11'-5" FREIGHT RM. = 13'-3"
 OIL LAMPS
 OUTSIDE TOILETS

RIVER DIV
 OFFICE SUB
 STATION 1160

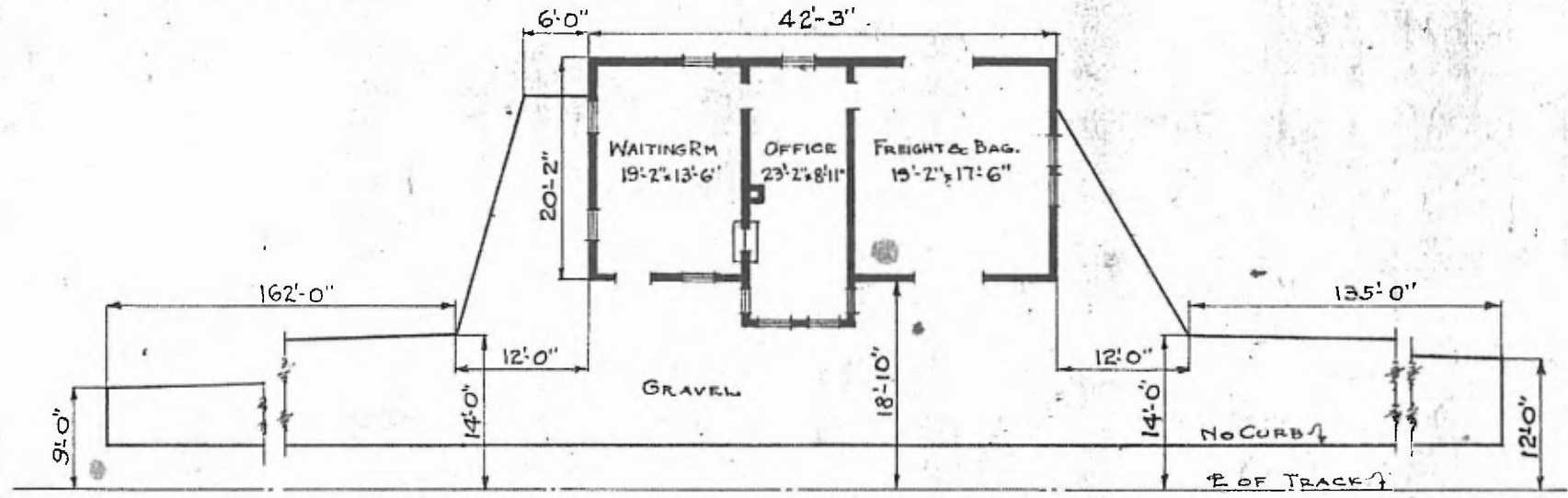

FLOOR PLAN
 SCALE: 1/16" = 1'-0"

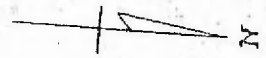

COMBINATION STATION
 McMULLIN, MO.

OCT. 2, 1919