

ERECTED 1896  
 TYPE FRAME  
 FOUNDATION PILE HEADS  
 WALLS 2"x4"  
 ROOF { TYPE - GABLE - SHINGLES  
 PITCH - 1/3  
 HEATING STOVES

FLOOR 7/8" x 3 1/4"  
 FINISH { INSIDE 7/8" x 3 1/4" M. & B.  
 OUTSIDE 7 1/2" DROP SIDING.  
 CEILING HEIGHT 13'-2"  
 LIGHTING OIL LAMPS.  
 SANITARY FACILITIES - OUTSIDE TOILETS

NORTH ELEVATION  
 CARTHAGE 305

73

STANDARD F322

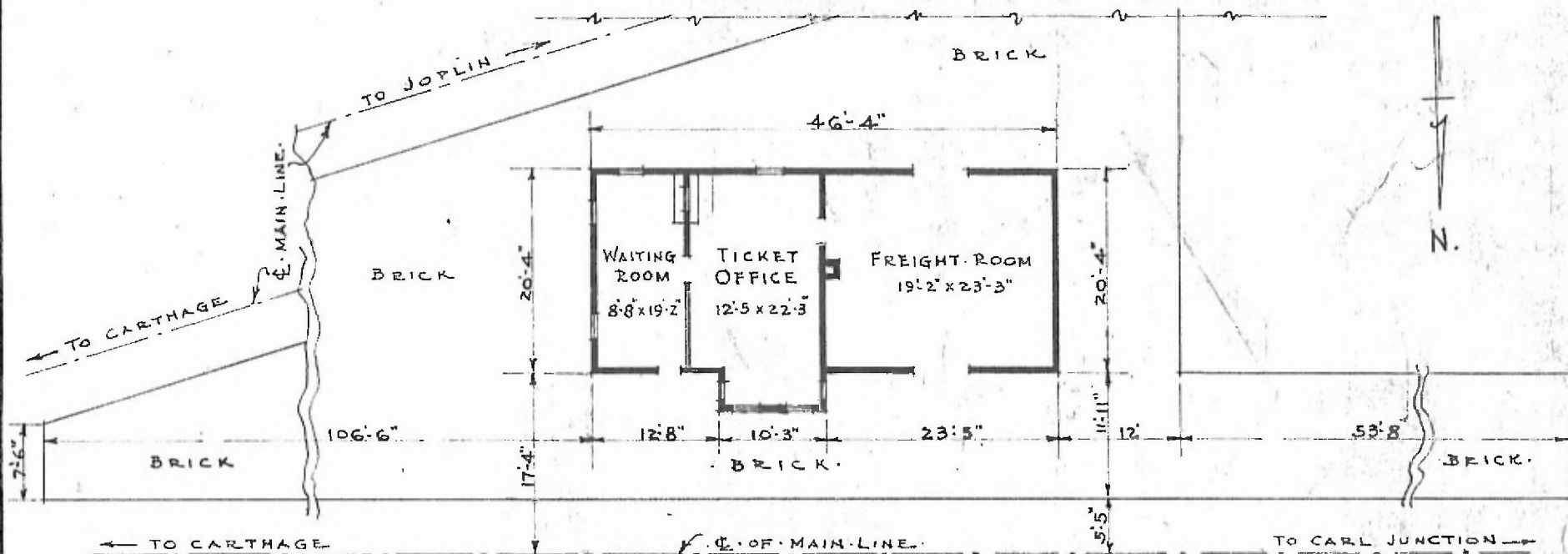

FLOOR PLAN

SCALE: 1/16" = 1'-0"

DESTROYED BY FIRE

PASSENGER STATION AT  
 ORONOGO JCT. MO.

MAY 18 1915