

ERECTED 1900
 TYPE FRAME
 FOUNDATION PILES
 WALLS 2x6
 ROOF { TYPE HIP-SHINGLES
 PITCH $\frac{1}{3}$
 HEATING STOVES

FLOOR $7/8 \times 3/4$
 FINISH { INSIDE $7/8 \times 3/4$ M. & B.
 OUTSIDE
 CEILING HEIGHT 12'-0"
 LIGHTING OIL
 SANITARY FACILITIES OUTSIDE TOILETS

RIVER DIV.
 LEACHVILLE SUB
 STA. NO. TD 203

109

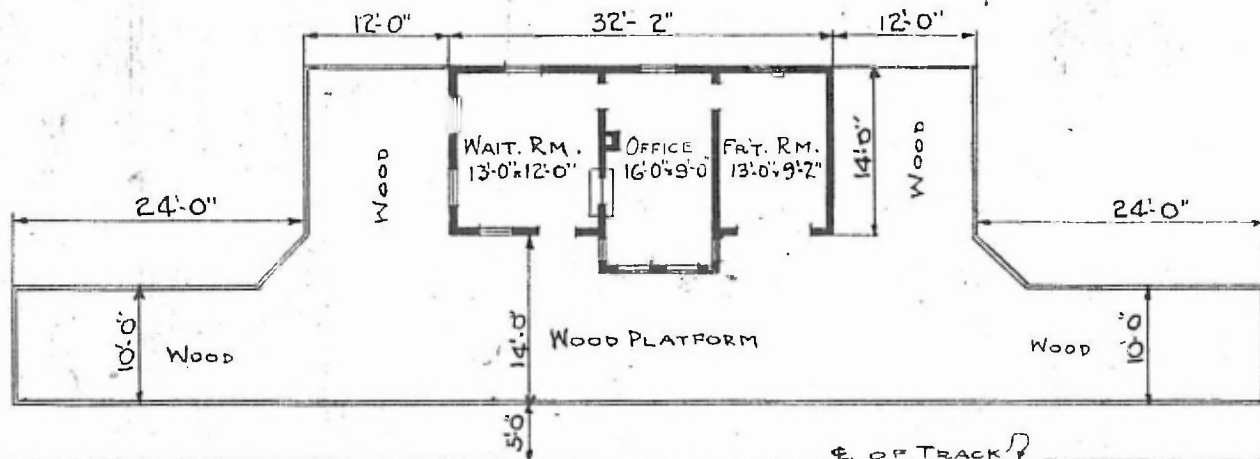

FLOOR PLAN
 SCALE: $\frac{1}{16}'' = 1'-0''$

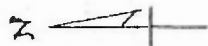

COMBINATION STATION
 POWE, MO.

SEP. 26, 1919