

ERECTED 1905
 TYPE FRAME
 FOUNDATION PILES
 WALLS 2x6
 ROOF { TYPE GABLE-SHINGLE
 PITCH 1/3
 HEATING STOVES

FLOOR 1
 FINISH { INSIDE 1/8" 3/4
 OUTSIDE 1/8" 3/4 M. & B
 CEILING HEIGHT DROP SIDING
 LIGHTING WAITING ROOM = 11' 5" FRT. RM. = 13' 3"
 SANITARY FACILITIES ELECTRIC
 OUTSIDE TOILETS

RIVER DIV.
 HOXIE SUB
 STA. NO. TA 175

57

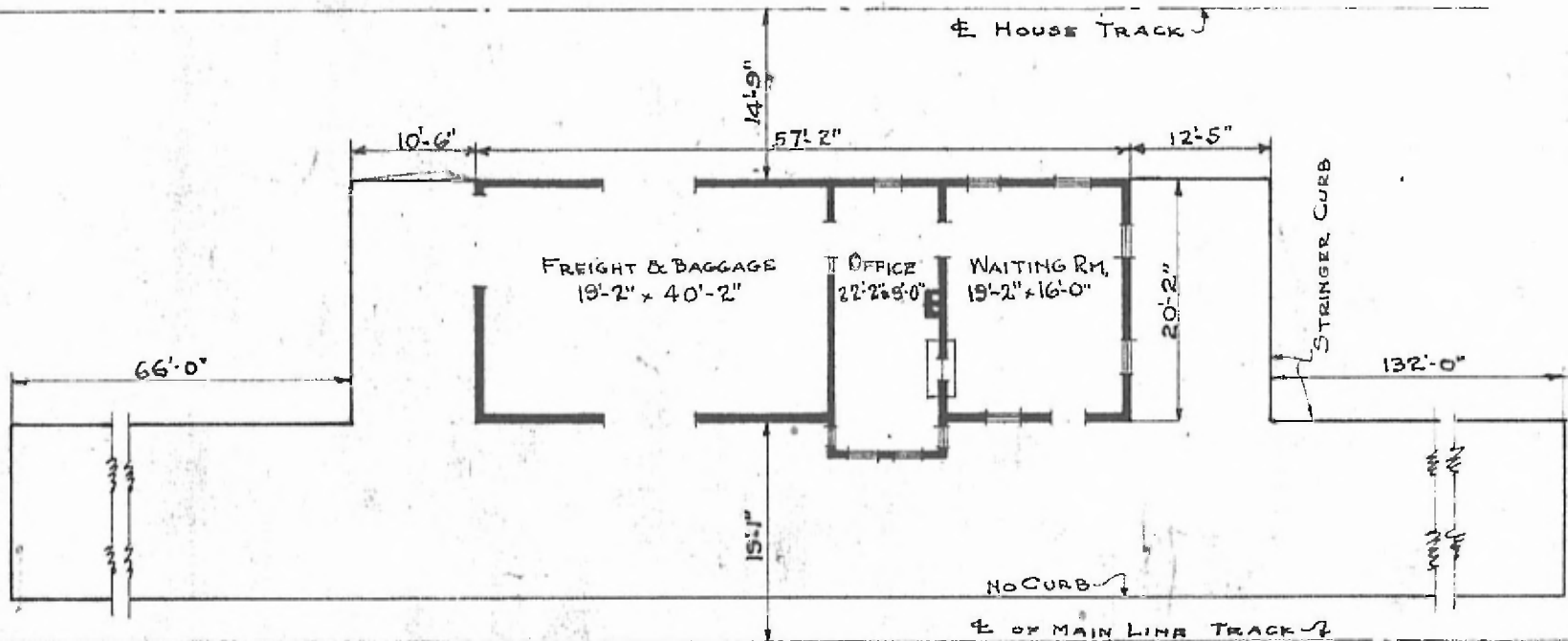

FLOOR PLAN
 SCALE: 1/16" = 1'-0"

COMBINATION STATION
 PUXICO, MO.