

ERECTED 1885.  
 TYPE. FRAME.  
 FOUNDATION PILE HEADS  
 WALLS 2'x6"  
 ROOF { TYPE GABLE SHINGLE.  
 PITCH 1/3  
 HEATING STOVES.

FLOOR 7/8" x 3 1/4" PINE.  
 FINISH { INSIDE 7/8" x 3 1/4" BEADED.  
 OUTSIDE BOARDS & BATTENS.  
 CEILING HEIGHT 15'-2" FR. 15'-3"  
 LIGHTING ELECTRIC.  
 SANITARY FACILITIES. OUTSIDE

EASTERN DIV.  
 LEASING SUB  
 STA. NO. 160

41

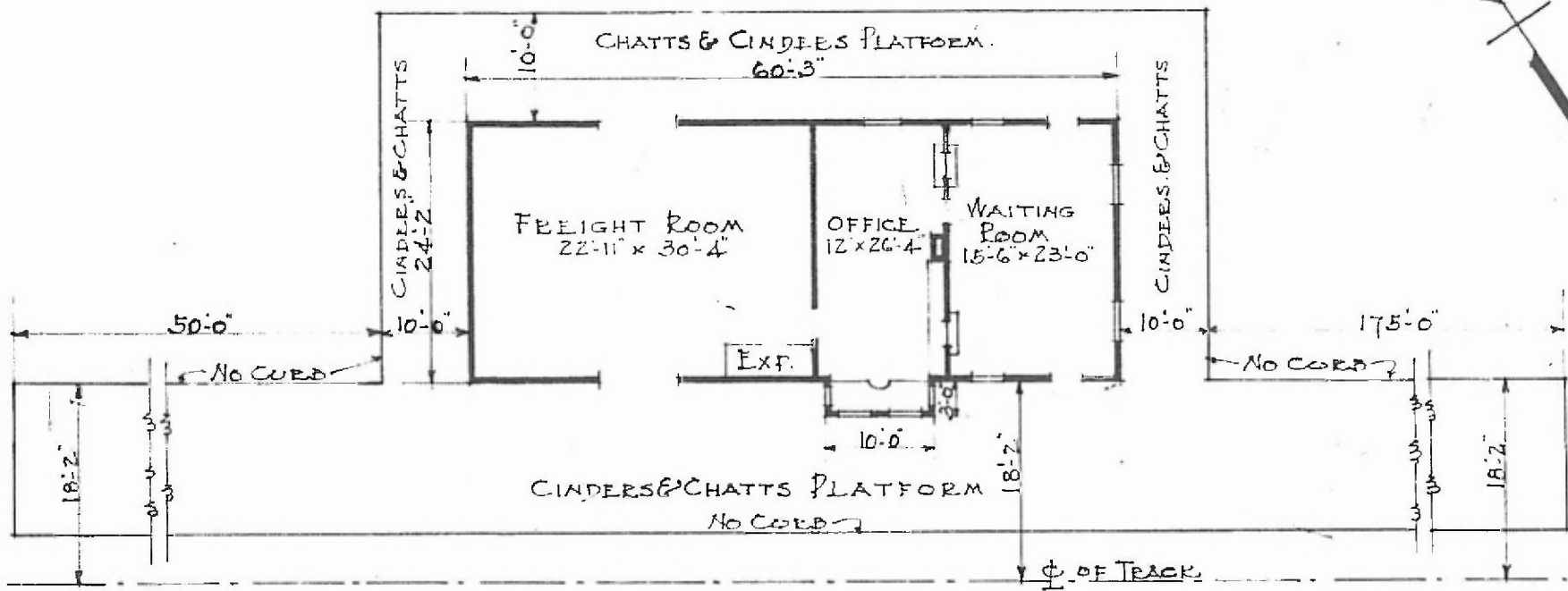

FLOOR PLAN.  
 SCALE = 1/16" = 1'-0".

DEC. 14. 1916.

PASSENGER STATION  
 RICHLAND, MO.