

ERECTED  
 TYPE  
 FOUNDATION  
 WALLS  
 ROOF { TYPE  
 PITCH  
 HEATING

FRAME  
 PILE HEADS  
 2x6"  
 GABLE SHINGLES  
 $\frac{1}{3}$   
 STOVES

FLOOR  
 FINISH { INSIDE  
 OUTSIDE  
 CEILING HEIGHT  
 LIGHTING  
 SANITARY FACILITIES

RIVER DIV.  
 ST. LOUIS SUB  
 STATION T 47  
 $\frac{1}{8} \times \frac{3}{4}$   
 $\frac{3}{4} \times \frac{3}{4}$  M. & B.  
 BOX & BATT -  $\frac{7}{8} \times \frac{5}{4}$ " DROP SIDING  
 WAITING RM. 11'10" - FREIGHT RM. 11'11"  
 OIL  
 OUTSIDE TOILETS

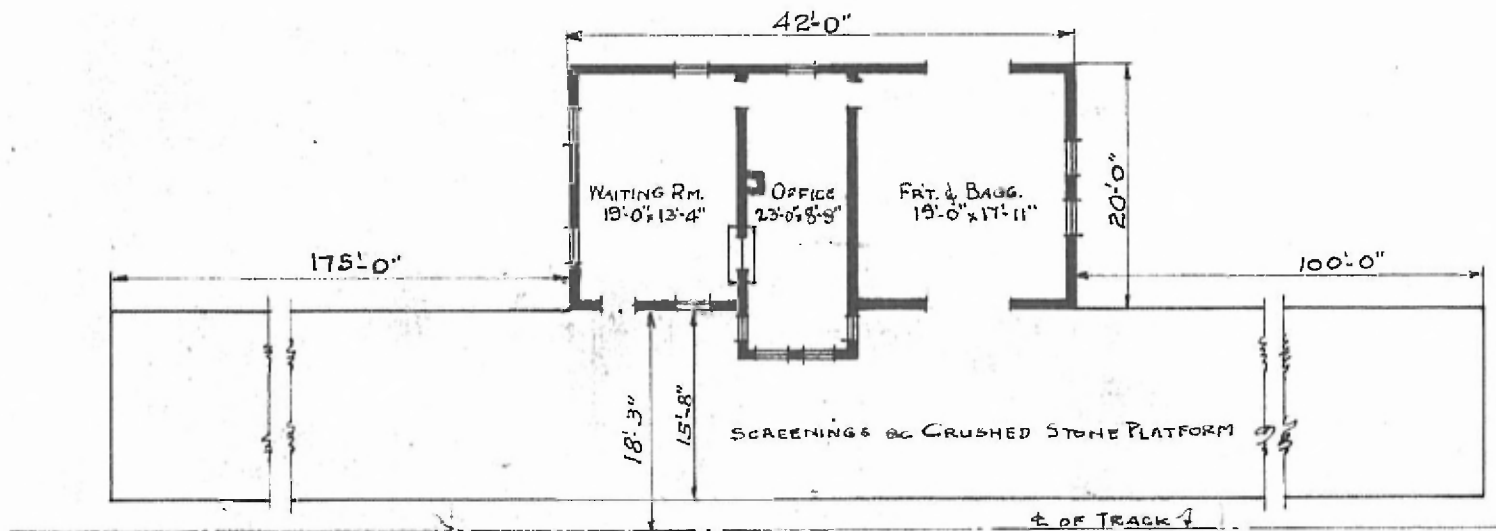

FLOOR PLAN  
 SCALE:  $\frac{1}{16}'' = 1'-0''$

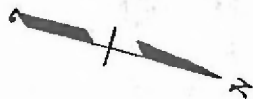

COMBINATION STATION  
 RUSH TOWER, MO.

MARCH 8<sup>TH</sup>, 1918