

100

ERECTED 1914  
 TYPE FRAME  
 FOUNDATION CONCRETE  
 WALLS 2+6  
 ROOF { TYPE HIP-SHINGLES  
       PITCH 10" RISE  
 HEATING STOVES

FLOOR  
 FINISH { INSIDE  
           OUTSIDE  
 CEILING HEIGHT 11'-2"  
 LIGHTING OIL  
 SANITARY FACILITIES OUTSIDE TOILETS

7" <sup>1</sup>/<sub>8</sub> x 3 1/4"  
 7" <sup>1</sup>/<sub>8</sub> x 3 1/4" M. & V-JOINT  
 4" LAP SIDING - 7" <sup>1</sup>/<sub>8</sub> x 5 1/4" DROP SIDING

RIVER DIV.  
 LERCHVILLE SUB  
 STA. NO. TE 234

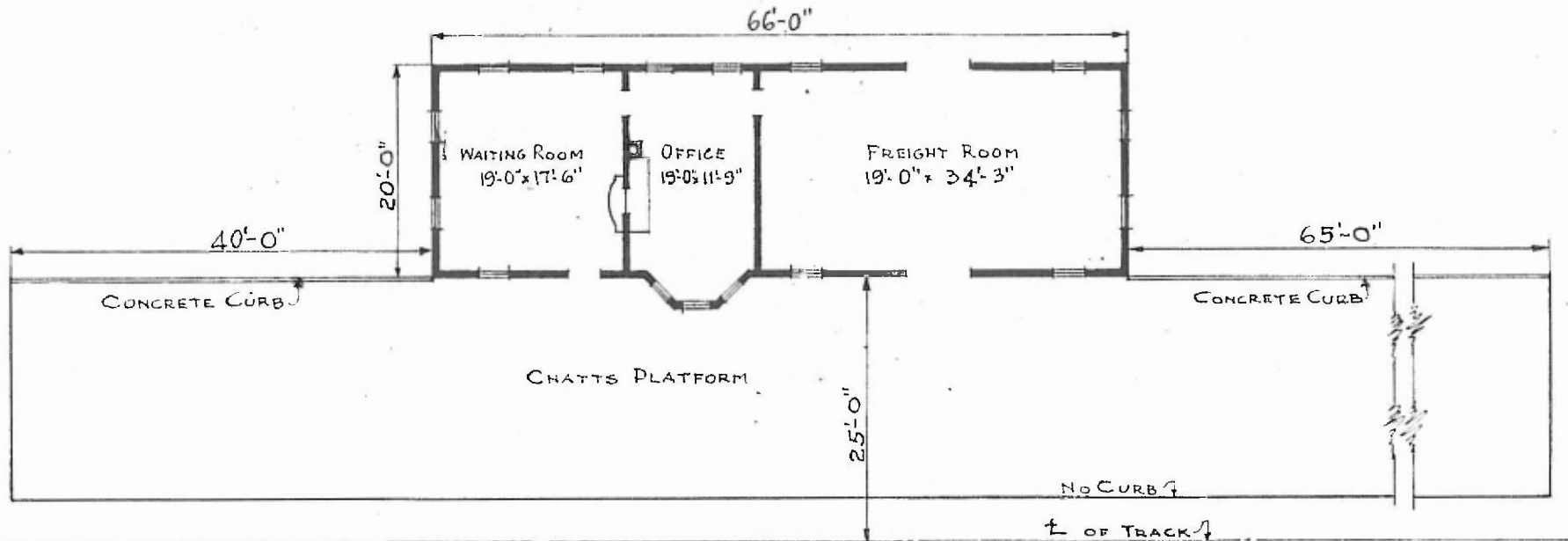

FLOOR PLAN  
 SCALE: <sup>1</sup>/<sub>16</sub>" = 1'-0"



COMBINATION STATION  
 SENATH, MO.

SEP 24, 1919