

ERECTED TYPE FRAME
 FOUNDATION WOOD BLOCKS
 WALLS 2" x 6"
 ROOF { TYPE GABLE, SHINGLES.
 PITCH 1/3
 HEATING STOVES

FLOOR FINISH { INSIDE
 OUTSIDE
 CEILING HEIGHT 10' 0"
 LIGHTING ELECTRIC
 SANITARY FACILITIES OUTSIDE TOILETS.

EASTERN DIV.
 ROLLER 305
 STR. NO. 9R

9

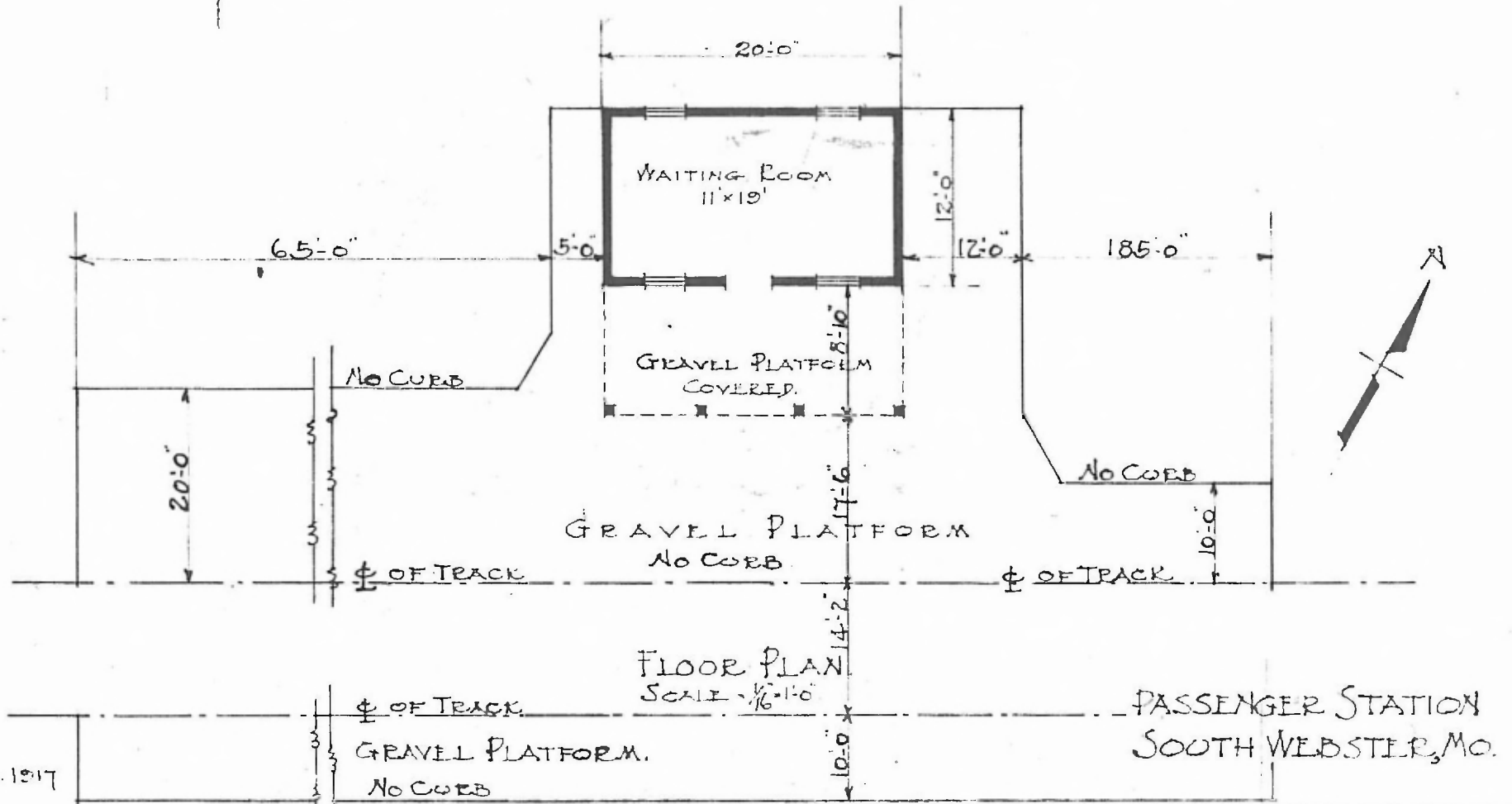

FEB. 1. 1917