

ERECTED 1913
 TYPE FRAME-STD#3.
 FOUNDATION CONCRETE
 WALLS 2"x6"
 ROOF { TYPE HIP-SHINGLES
 PITCH 1/3
 HEATING STOVES

FLOOR FINISH { INSIDE
 { OUTSIDE
 CEILING HEIGHT 11'-6"
 LIGHTING OIL LAMPS
 SANITARY-FACILITIES- OUTSIDE TOILETS.

MAPLE & 2"x6" No.1-Y.P.
 3/4"x3/4"-V. JOINT CEILING.
 4"HOUSE SIDING-&-DROPSIDING.

EASTERN DIV.
 SPRINGFIELD SUB
 STA. NO. A 265

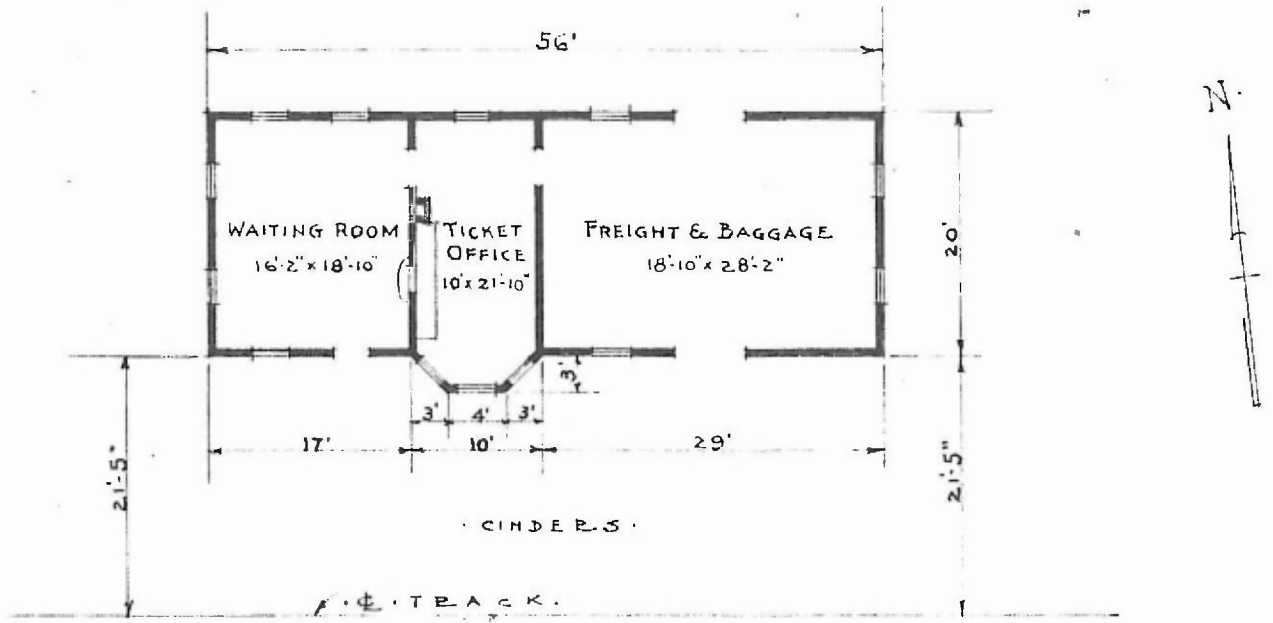

FLOOR PLAN
 SCALE: 1/16" = 1'-0"

PASSENGER STATION AT
 SPARTA MO.