

ERECTED. 1912
 TYPE. BRICK.
 FOUNDATION. CONCRETE.
 WALLS. 13" BRICK.
 ROOF { TYPE. HIP TILE.
 PITCH. 1/3

FLOOR. 3/8" x 3/4" MAPLE. CONCRETE.
 FINISH { INSIDE. PLASTER. STEEL CEILINGS.
 OUTSIDE. BRICK
 CEILING HEIGHT. 12'-6". BAG & EXP. 12'-10"
 LIGHTING. ELECTRIC.
 SANITARY FACILITIES. OUTSIDE.

DIV. SOUTHWESTERN
 SUB. DIV. CALIFORNIA
 STA. No. G 348

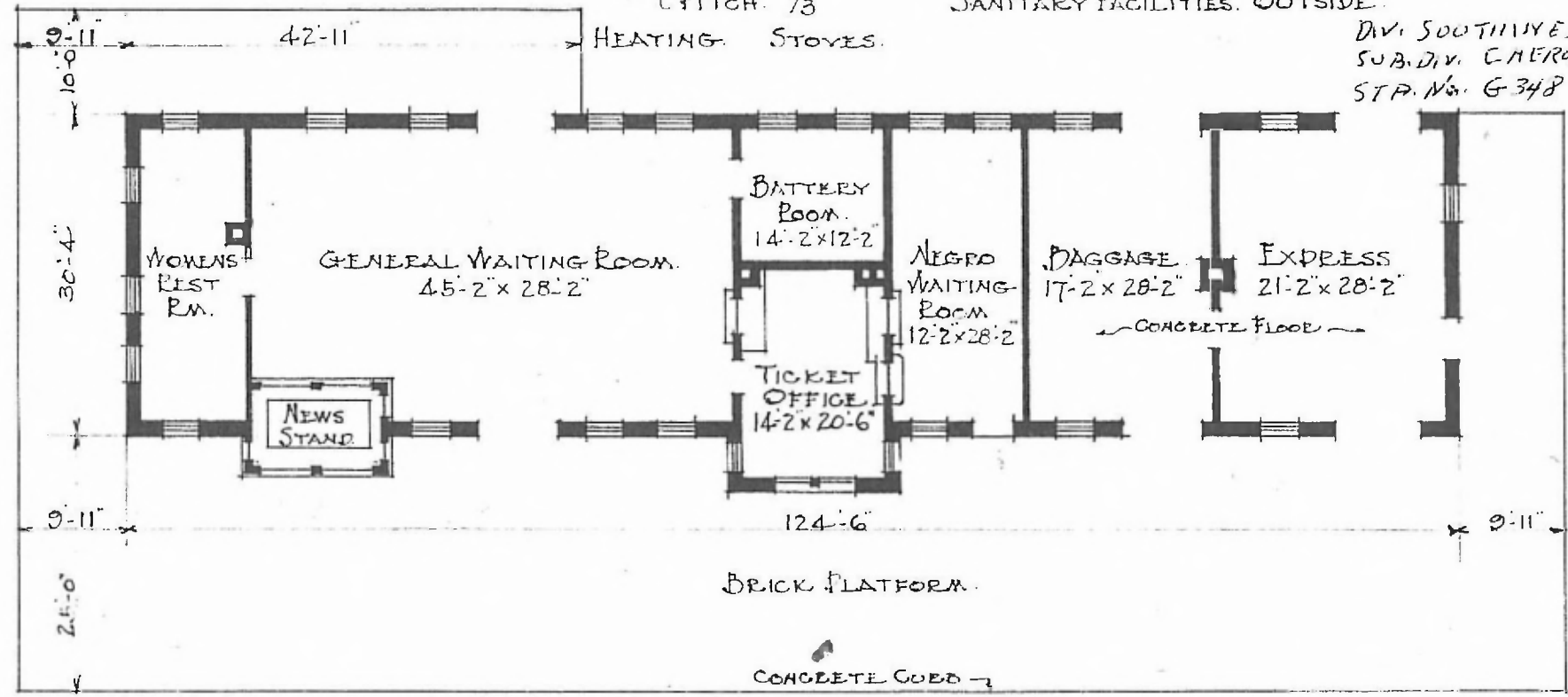

FLOOR PLAN.
 SCALE - 1/16" = 1'-0"

PASSENGER STATION AT
 AFTON, OKLA.

AUG. 3, 1916.

