

ERECTED. 1913
 TYPE. BRICK.
 FOUNDATION. CONCRETE.
 WALLS. 12" BRICK.
 ROOF. { TYPE
 PITCH COMPOSITION.
 FLAT.
 HEATING. STOVES.

FLOOR. CONCRETE.
 FINISH. { INSIDE
 OUTSIDE PLASTER.
 BRICK.
 CEILING. HEIGHTS. 11' 3"
 LIGHTING. ELECTRIC. LIGHT.
 SANITARY. FACILITIES. INSIDE. TOILETS.

DIV. CENTRAL
 SUB-DIV. ARTHUR
 STA. ANTLERS
 STA No. 542

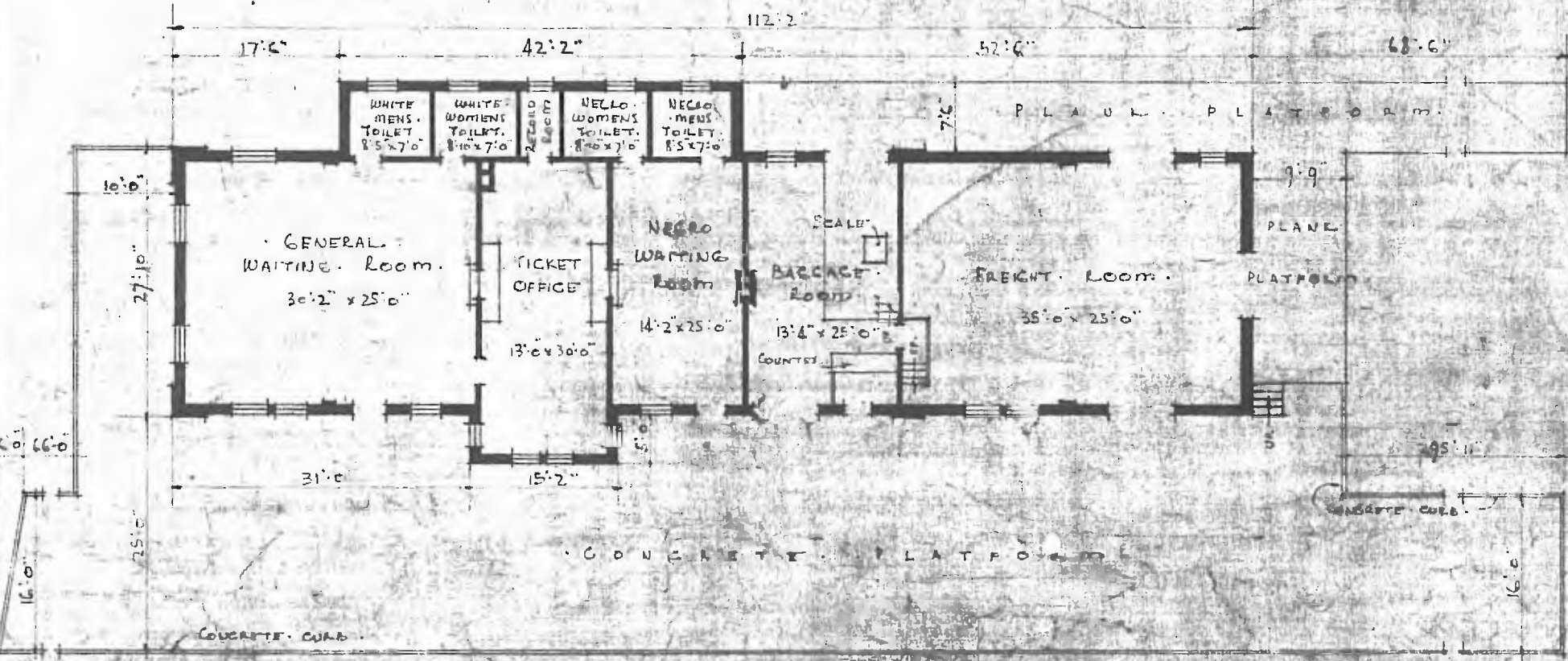

FLOOR PLAN
 SCALE 1" = 10'

COMBINATION STATION AT
 ANTLERS - OKLAHOMA

N.
 April 8, 1915