

62.

ERECTED	1904.	FLOOR	2 1/2" OAK IN OFFICE; 3/4" x 3 1/2" YELLOW PINE IN W. R.
TYPE	FRAME	FINISH	{ INSIDE: 3/4" x 3 1/2" BD. CEILING; OUTSIDE: BOARDS & BATTS - 1" x 6" DROP SIDING.
FOUNDATION	PILE HEADS	CEILING HEIGHTS	11'0" WAITING ROOMS; T.O.; 14'0" F. E. B. ROOMS
WALLS	2 x 6 STUDS	LIGHTING	OIL LAMPS
ROOF	{ TYPE: GABLE - SHINGLES PITCH: APPROX. 1/3 PITCH	SANITARY FACILITIES	OUTSIDE TOILETS
HEATING	STOVES		

*Western
Avard
2607*

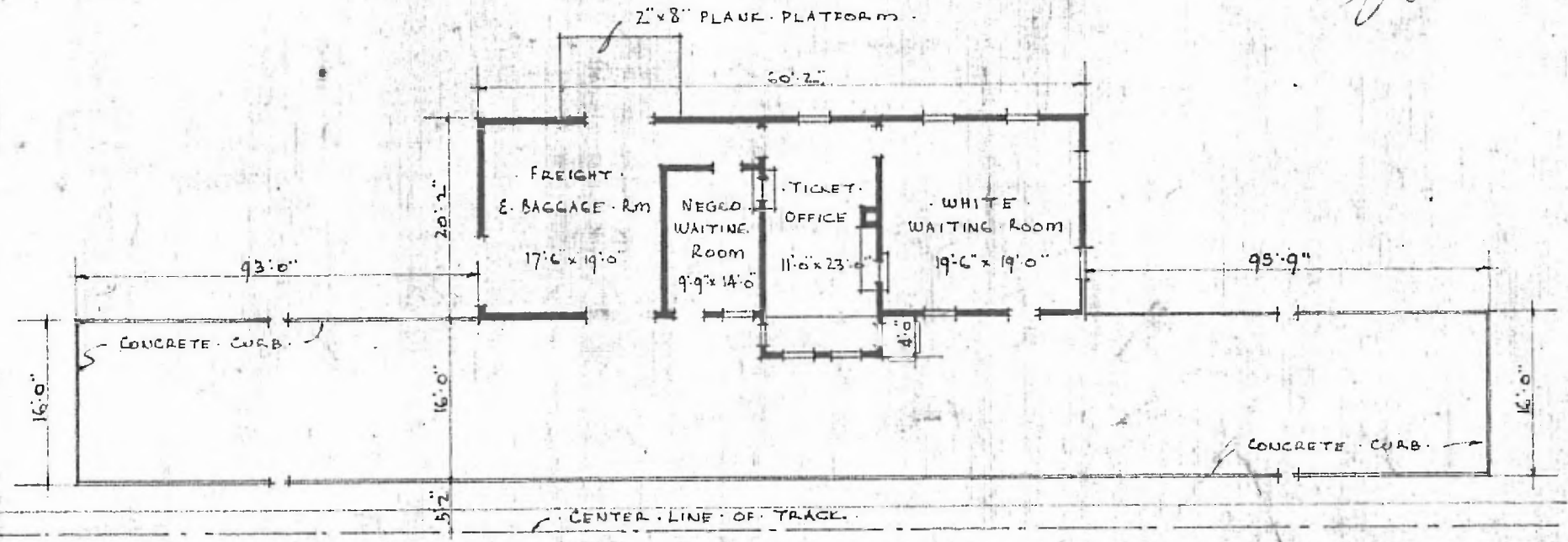

FLOOR PLAN
SCALE 1/16" = 1'0"

COMBINATION STATION AT
AVARD - OKLA

N. 

JULY 6 - 1917.