

ERECTED 1898 WHEN ROAD WAS CONSTRUCTED.  
 TYPE . FRAME.  
 FOUNDATION . PILE HEADS.  
 ROOF { TYPE . GABLE . SHINGLE.  
 { PITCH . 1/3  
 HEATING . COAL STOVES.

FLOOR 3/4 x 3 1/4 PINE.  
 FINISH { INSIDE 3/4 x 3 1/4 BEADED V JOINT CEILING  
 { OUTSIDE . BOARDS & BATTONS & 1x6 DROP S.D.G.  
 CEILING HEIGHT . 11-4  
 LIGHTING . ELECTRIC LIGHTS (FIXED FOR GAS)  
 SANITARY FACILITIES . INSIDE TOILETS

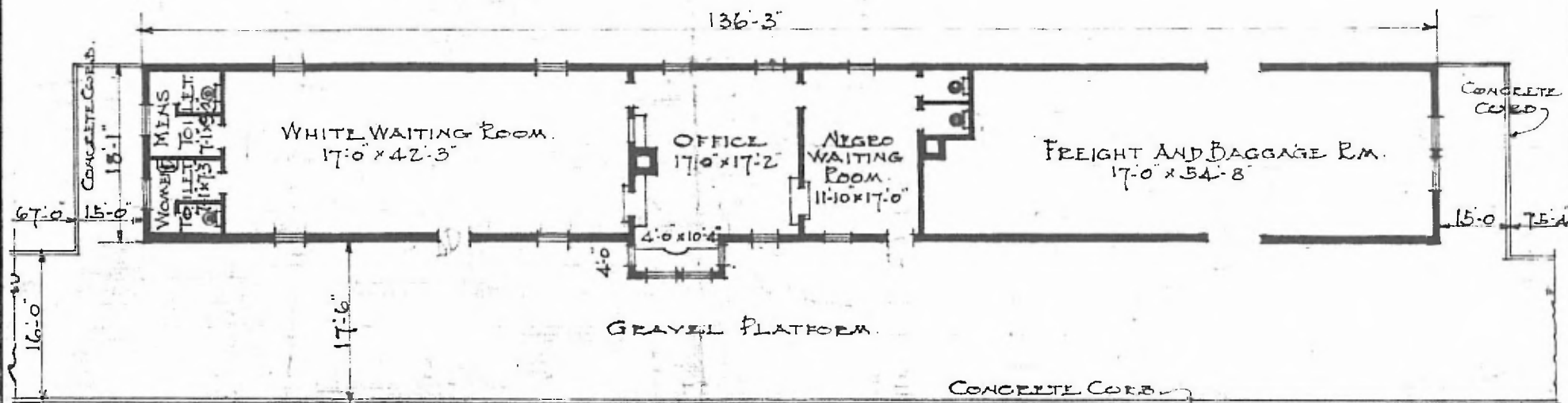

FLOOR PLAN.  
 SCALE 1/16" = 1'-0"

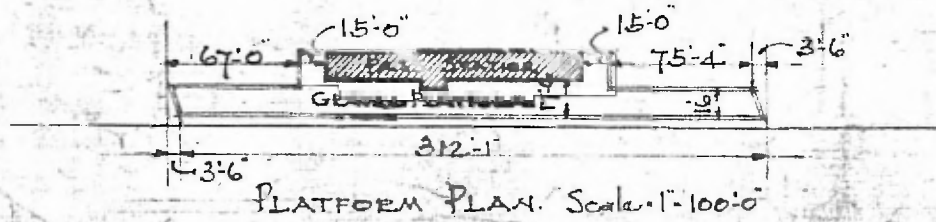

COMBINATION STATION AT  
 BRISTOW - OKLA.  
 FEB. 21. 1916.