

S.W. - DIV. RED RIVER
 SUB-DIV. CREEK
 STATION E-488

15

ERECTED TYPE
 FOUNDATION WALLS
 ROOF { TYPE PITCH
 HEATING

1917
 STD. FRAME
 CONCRETE 2" x 6"
 HIP SHINGLES
 STD.
 STOVES

FLOOR FINISH { INSIDE OUTSIDE
 CEILING HEIGHT
 LIGHTING
 SANITARY FACILITIES

3" x 3 1/4" Y.P.
 V-JOINT
 1 1/2" DROP SIDING
 STD.
 LAMPS
 OUTSIDE TOILETS

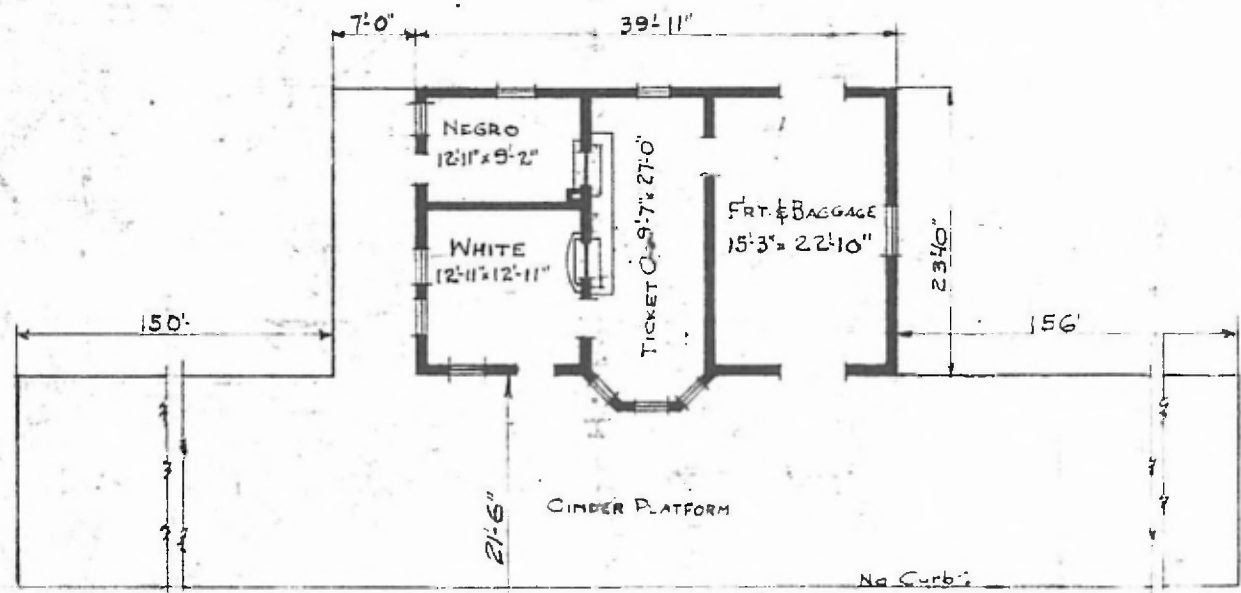

FLOOR PLAN
 SCALE 1/16" = 1'-0"



COMBINATION STATION AT
 BRYANT, OKLA.

JULY 28, 1919