

ERECTED 1910
 TYPE STANDARD NO. 2
 FOUNDATION PILE HEADS.
 WALLS 2"x6"
 ROOF TYPE - HIP WOOD SHINGLES.
 PITCH - 9 1/2 x 12
 HEATING STOVES

FLOOR FINISH { INSIDE
 { OUTSIDE
 CEILING HEIGHT 11'-4"
 LIGHTING OIL LAMPS.
 SANITARY FACILITIES - OUTSIDE TOILETS.

3/4" x 3/4" Y.P. - 2 1/4" MAPLE IN OFFICE
 3/4" x 3/4" Y. JOINT CEILING
 3/4" x 5/4" COVE SIDING.
 DIV. SOUTHWESTERN
 SUB. DIV. CHEROKEE
 STA. NO. G 585

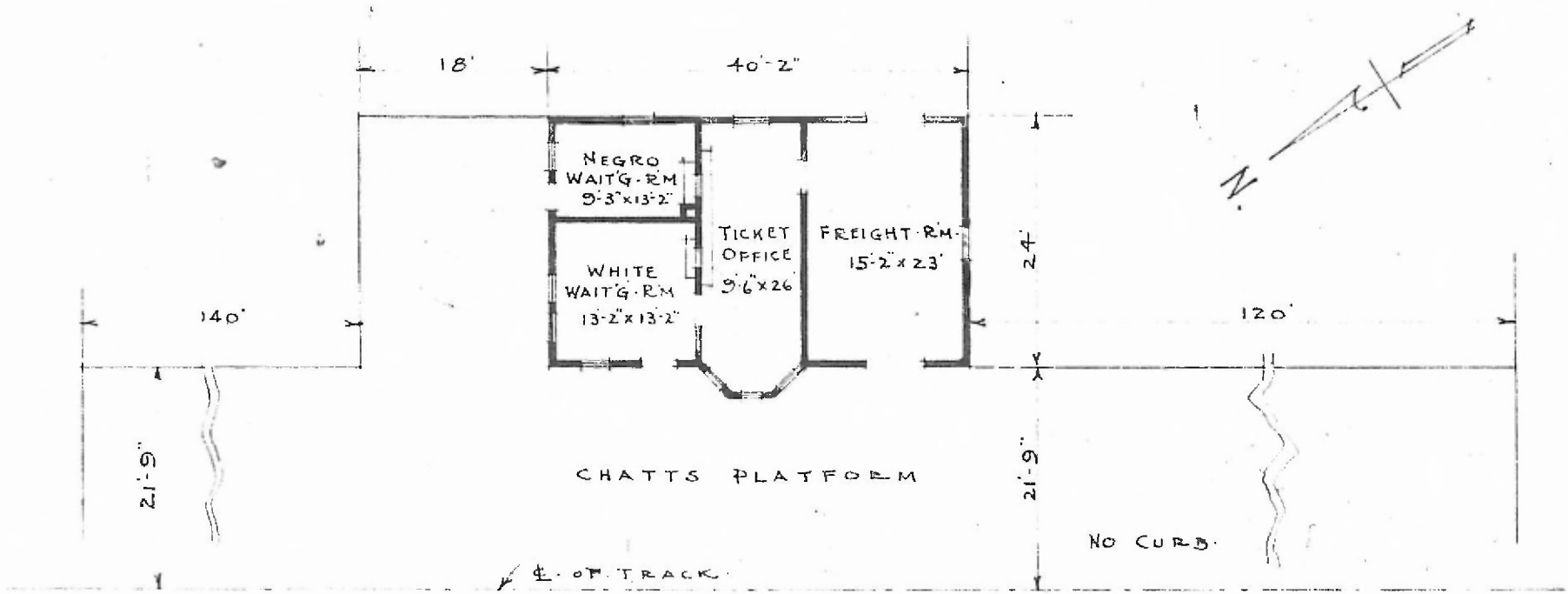

FLOOR PLAN
 SCALE: 1/16" = 1'-0"

PASSENGER STATION AT
 BUSHYHEAD OKLA.