

ERECTED - 1904.
 TYPE - FRAME.
 FOUNDATION - PILE HEADS.
 WALLS - 2" X 6" STUDS.
 ROOF - { TYPE - GABLE - SHINGLES.
 PITCH - APPROX. $\frac{1}{3}$ PITCH.
 HEATING - STOVES.

FLOOR - $\frac{3}{4}$ " X $3\frac{1}{2}$ " YELLOW PINE.
 FINISH - { INSIDE - $\frac{3}{4}$ " X $3\frac{1}{2}$ " BD. CEILING.
 OUTSIDE - BOARDS & BATTIS - 1" X 6" DROP SIDING.
 CEILING HEIGHTS - 14'0" WAITING ROOMS; T.O.; - 14'8" F.E.O. ROOMS.
 LIGHTING - ELECTRIC LIGHTS.
 SANITARY FACILITIES - OUTSIDE TOILETS.

59.

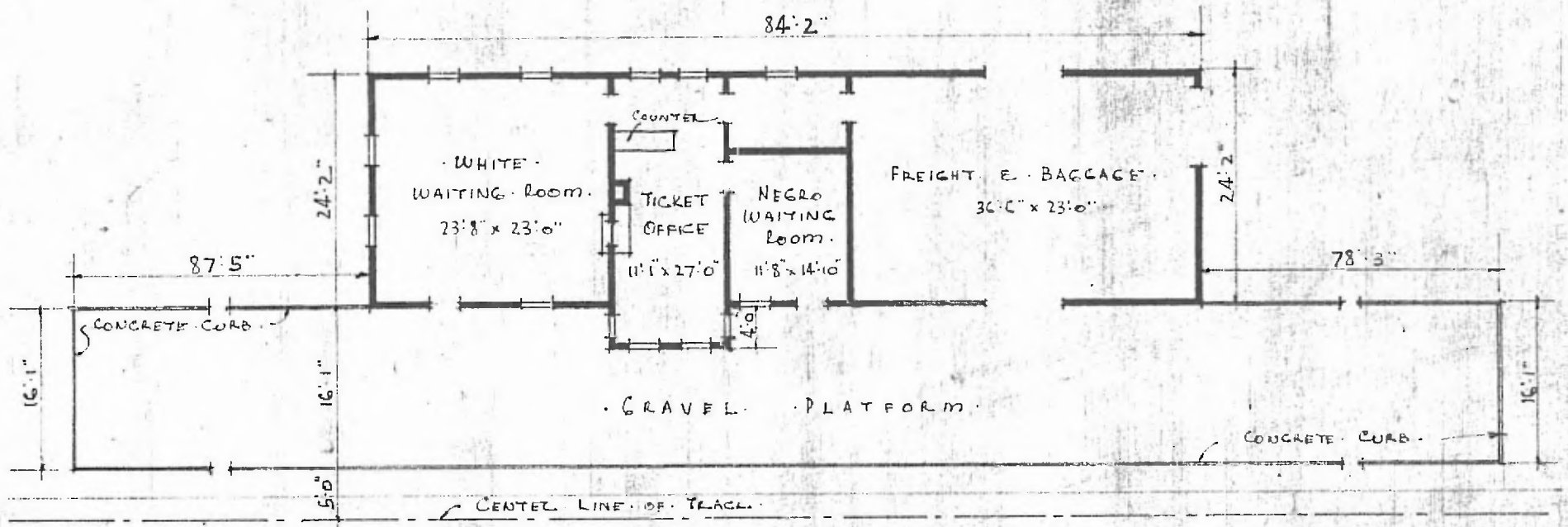

FLOOR PLAN
 SCALE: $\frac{1}{16}$ " = 1'-0"



Div. Western
 Sub. Div. AVARD
 Sta. No. - 2581

COMBINATION STATION AT
 CARMEN - OKLA

JULY 3 1917.