

ERECTED 1900.
TYPE STANDARD No. 2
FOUNDATION FILE HEADS.
WALLS 2x6"
ROOF { TYPE WOOD SHINGLES.
PITCH 9 1/2" PER FT.
HEATING STOVES.

FLOOR MAPLE
FINISH { INSIDE 7/8 x 3/4" V. JOINT
OUTSIDE 7/8 x 5 1/4" COVE SIDING.
CEILING HEIGHT 11'-4"
LIGHTING OIL LAMPS.
SANITARY FACILITIES OUTSIDE TOILETS.

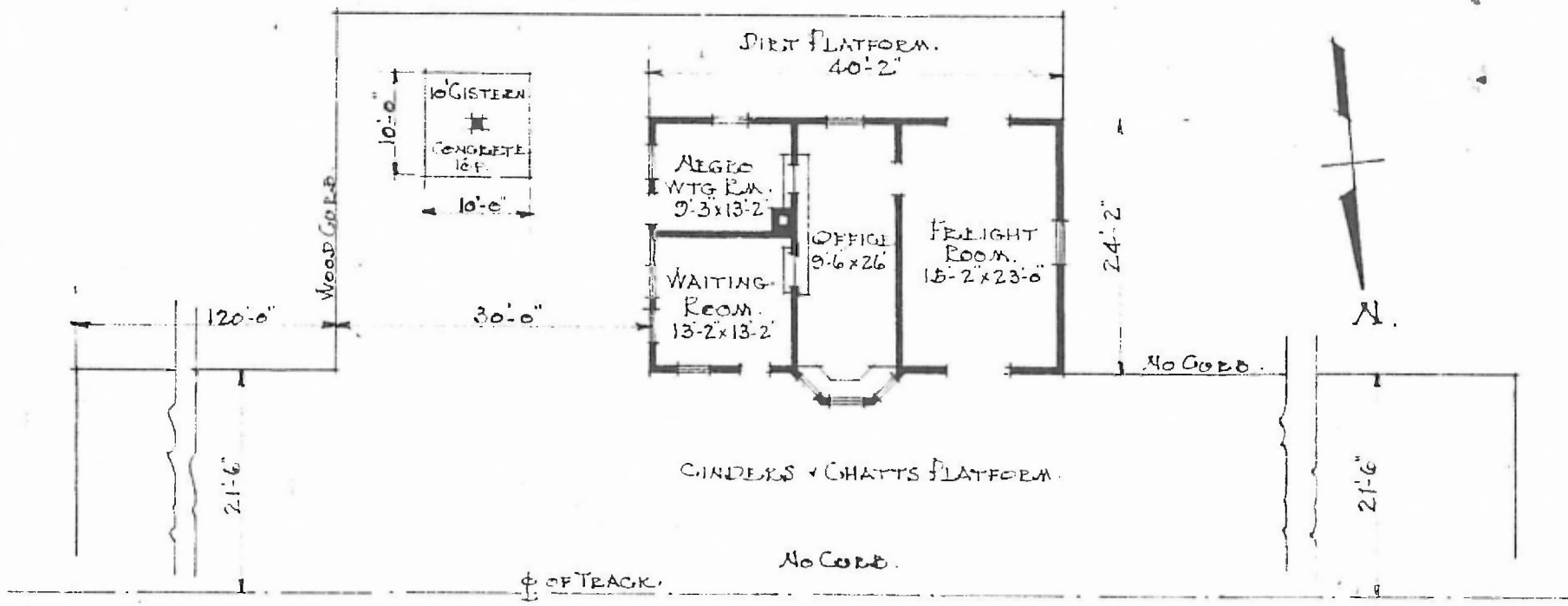

FLOOR PLAN
SCALE: 1/16" = 1'-0"

PASSENGER STATION AT
CATALE, OKLA.

July 27, 1917.