

·ERECTED· 1902
 ·TYPE· FRAME
 ·FOUNDATION· PILE HEADS
 ·WALLS· 2"x6"
 ·ROOF· { TYPE· GABLE, SHINGLES
 PITCH· 3
 ·HEATING· STOVES.

·FLOOR· 2"x3/4" Y.P. SUBDIV. CHICKASHA
 ·FINISH· { INSIDE· 2"x3/4" M.&P. STA. No. 6600
 OUTSIDE· BOARDS & BATTENS
 ·CEILING HEIGHT· 12'-2"
 ·LIGHTING· OIL LAMPS
 ·SANITARY FACILITIES· OUTSIDE TOILETS.

DIV. SOUTHWESTERN

77

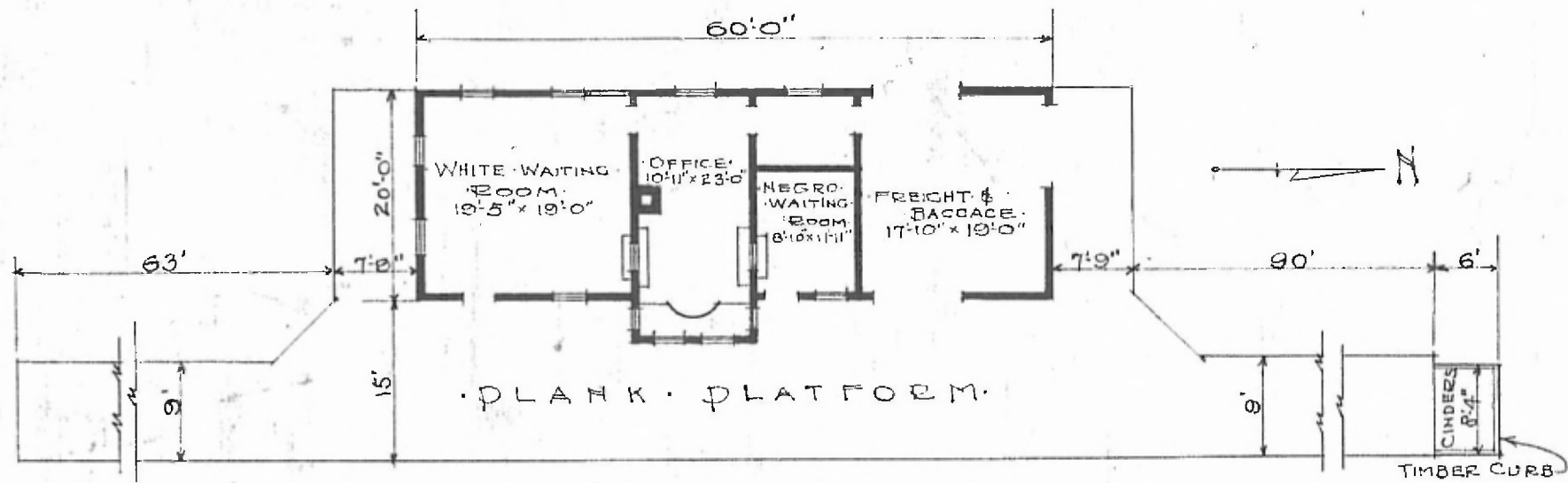

·FLOOR PLAN·
 SCALE 1/16" = 1'-0"

·COMBINATION· STATION·
 ·CEMENT· OKLA.

OCT. 20, 1916