

ERECTED 1916.
 TYPE FIREPROOF.
 FOUNDATION CONCRETE.
 WALLS STUCCO & TILE 8" THICK.
 ROOF TYPE FLAT COMPOSITION.
 PITCH 3/4" PER FOOT.
 HEATING STEAM.

FLOOR CEMENT
 FINISH { INSIDE PLASTER
 OUTSIDE STUCCO.
 CEILING HEIGHT 12'-0". TOILETS 10'-0". BAG. EXP. 15'-6"
 LIGHTING ELECTRIC.
 SANITARY FACILITIES SEE PLAN.

DIV. SOUTHWESTERN
 SUB. DIV. CHEROKEE
 STA. N. G-398

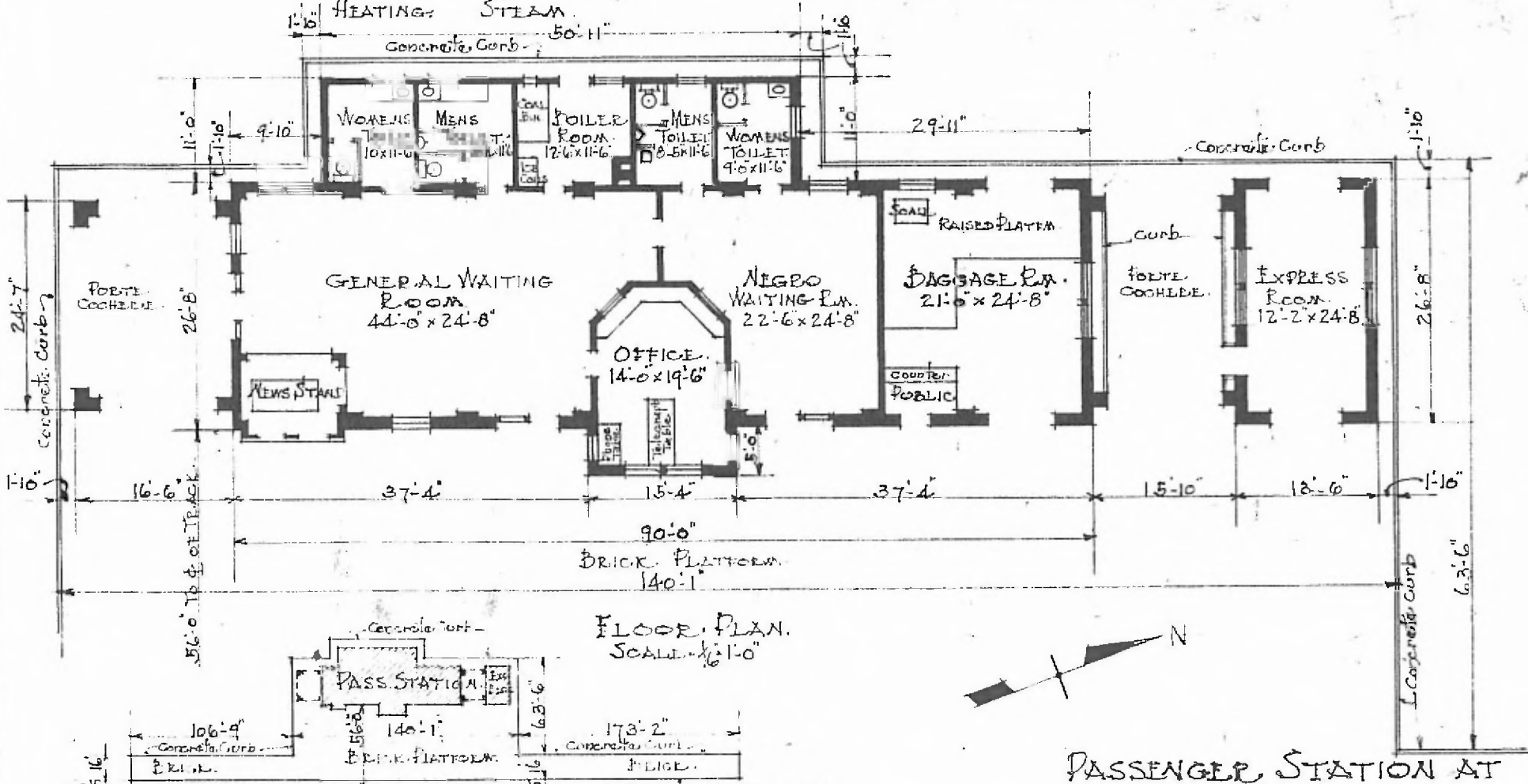

FLOOR PLAN.
 SCALE 1/16" = 1'-0"

PLOT PLAN. SCALE 1" = 100'-0"

PASSENGER STATION AT
 CLAREMORE, OKLA.

FEB. 29, 1916,