

78

• ERECTED: 1908
 • TYPE: FRAME.
 • FOUNDATION: CONCRETE.
 • WALLS: 2"x6"
 • ROOF: TYPE: HIP. SHINGLES.
 PITCH: 1/3
 • HEATING: STOVES.

• FLOOR: 3/4"x3/4" Y.P.
 • FINISH: { INSIDE: 3/4"x3/4" M.&B.
 OUTSIDE: DROP SIDING.
 • CEILING HEIGHT: 11'-4"
 • LIGHTING: OIL LAMPS.
 • SANITARY FACILITIES: OUTSIDE TOILETS.

DIV. SOUTH WESTERN
 SUB-DIV. CHICKASHA
 STA. No. G605

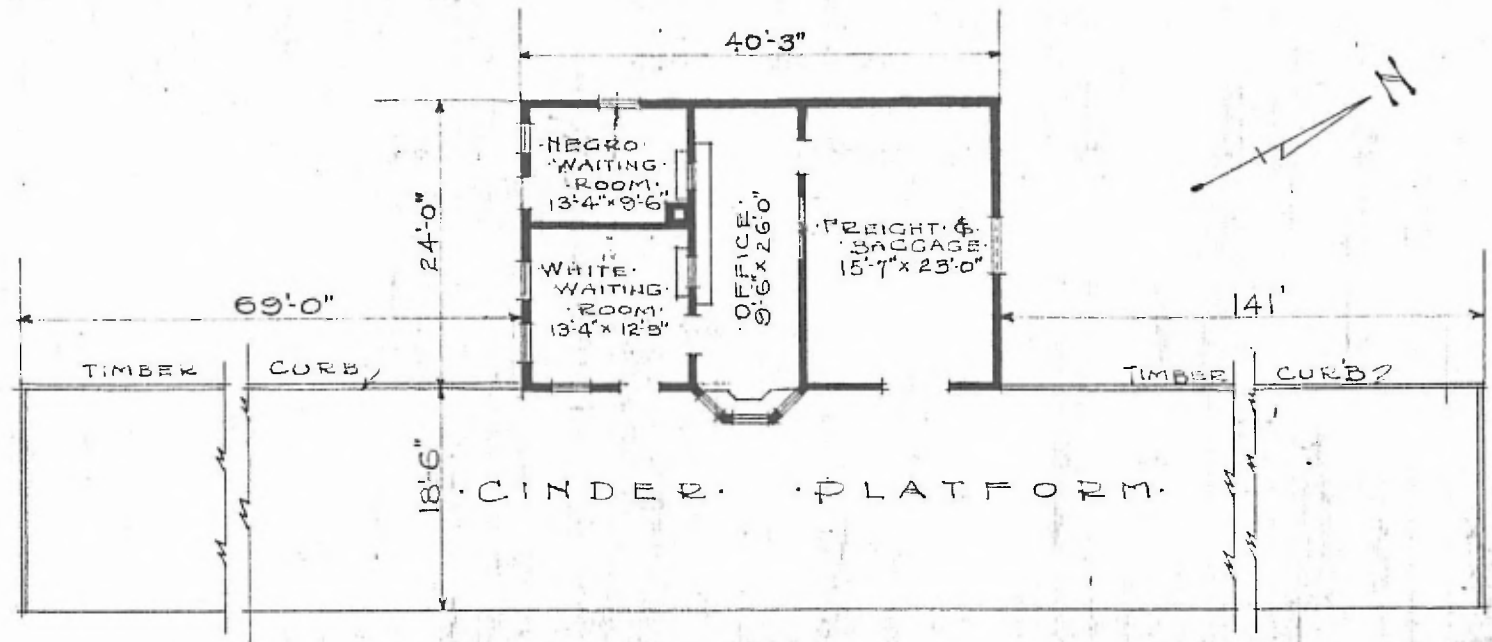

FLOOR PLAN
 SCALE 1/16" = 1'-0"

COMBINATION STATION
 CYRIL OKLA.

NOV. 18, 1916.