

• ERECTED: 1907
 • TYPE: FRAME
 • FOUNDATION: PILE HEADS
 • WALLS: 2" x 6"
 • ROOF: (TYPE: GABLE, SHINGLES
 PITCH: $\frac{1}{3}$)
 • HEATING: STOVES

• FLOOR: $\frac{3}{4}$ " x $\frac{3}{4}$ " Y.P.
 • FINISH: { INSIDE: $\frac{3}{4}$ " x $\frac{3}{4}$ " M. & B.
 OUTSIDE: BOARDS & BATTENS.
 • CEILING HEIGHT: 10'-5"
 • LIGHTING: OIL LAMPS
 • SANITARY FACILITIES: OUTSIDE TOILETS

Div. SOUTHWESTERN
 SUB-DIV. OKLAHOMA
 STA. No. G467

59

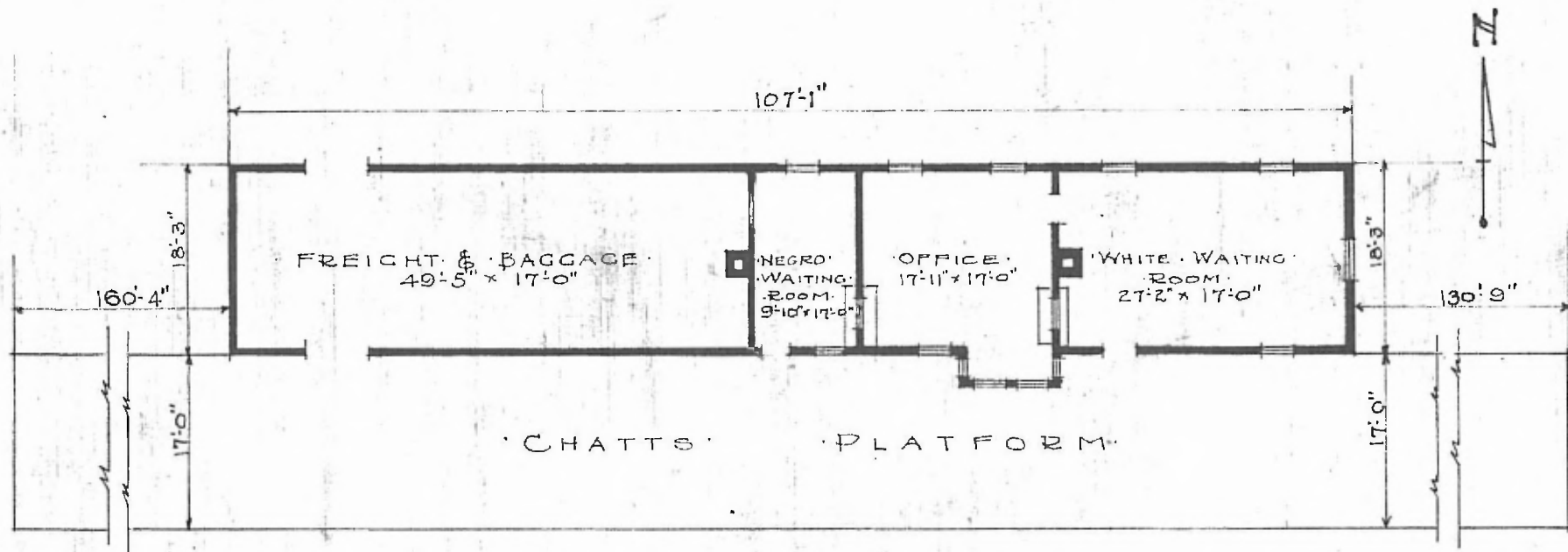

• FLOOR PLAN •
 • SCALE $\frac{1}{16}$ " = 1'-0"

• COMBINATION STATION •
 • DEPEW OKLA.

JULY 5, 1916