

ERECTED:	1903.	FLOORS	3/4 x 3 1/4 YELLOW PINE
TYPE:	FRAME.	FINISH	3/4 x 3/4 READED CEILING.
FOUNDATION:	PILE HEADS		
ROOF:	TYPE	CEILING HEIGHT:	12.2" FREIGHT 13.4"
	PITCH	LIGHTING:	OIL LAMPS
WALLS:	CABLE SHINGLE.	SANITARY FACILITIES OUTSIDE.	
HEATING:	APPROX. 3.	154' 0"	
	2 x 6" STUDS.		
	STOVES.		

DIV. SOUTHWESTERN
 SUB. DIV. CHICKASAW
 STA. NO 6709

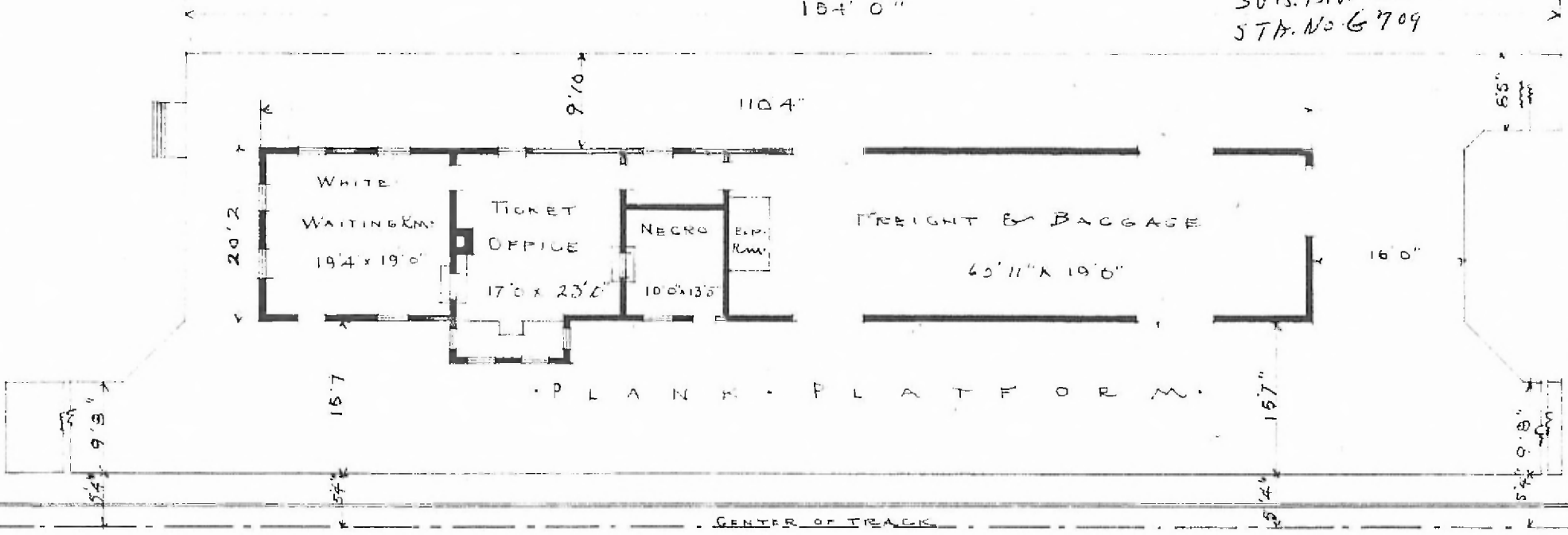

FLOOR PLAN
 SCALE 1/16" = 1'0"

DESTROYED BY FIRE 4-17-20

PASSENGER STATION AT
 ELDORADO OKLA.

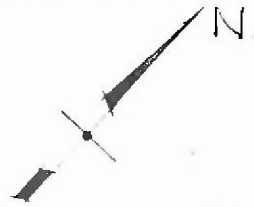

NOVEMBER 22 1916