

ERECTED: 1900.
 TYPE: FRAME.
 FOUNDATION: PILE HEADS.
 WALLS: 2' x 6"
 ROOF { TYPE: GABLE SHINGLES.
 PITCH: 1/3.
 HEATING: STOVES.

FLOOR: 3 1/4" Y. PINE.
 INSIDE: 3 1/4" BD. CEILING.
 FINISH { OUTSIDE: BOARD & BATTIS.
 CEILING HEIGHT: 12' 0"
 LIGHTING: LAMPS.
 SANITARY FACILITIES: OUTSIDE TOILETS.

S.W. DIV
 Sherman Sub
 E 558

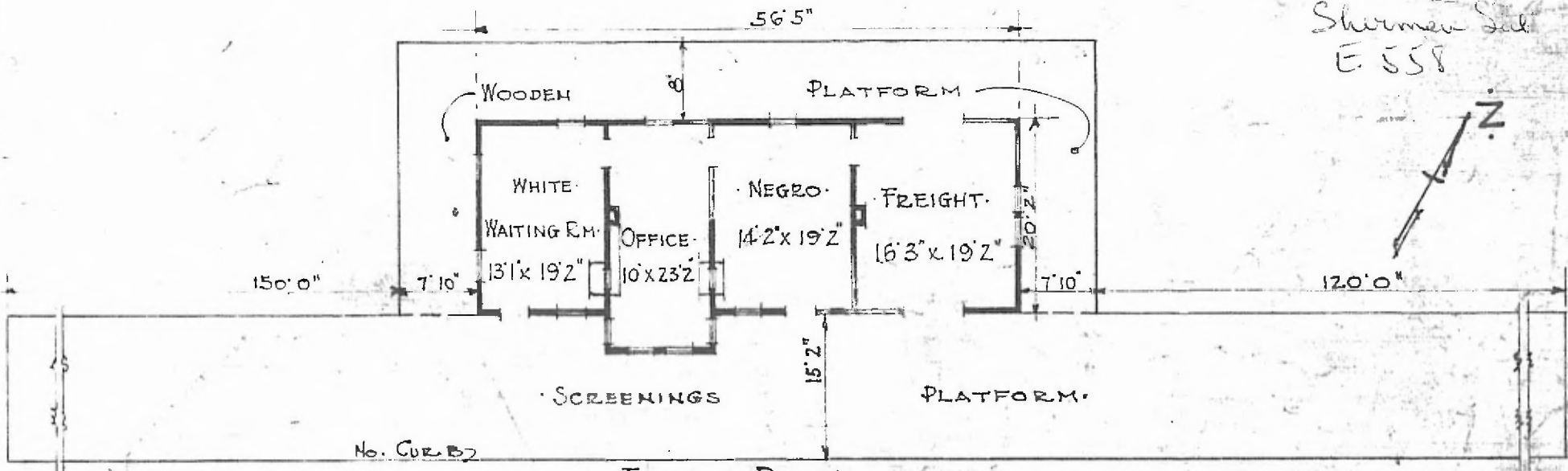

FLOOR PLAN.
 SCALE: 1/16" = 1' 0"

COMBINATION STATION AT
 FITZHUGH OKLA.

SEPT. 30. 1915.