

ERECTED:	1912	FLOORS:	2 1/2 MAPLE
TYPE:	FRAME	FINISH: {	V JOINT CEILING
FOUNDATION:	CONCRETE		INSIDE
ROOF: {	HIP SHINGLE	CEILING HEIGHT:	1 1/2" FREIGHT 1 1/4"
			FITCH:
WALLS:	2x6" STUD	LIGHTING:	SANITARY FACILITIES OUTSIDE
HEATING:	STOVES		

DIV. SOUTHWESTERN  
 SUB. DIV. CHICKASAW  
 STATION. 6626

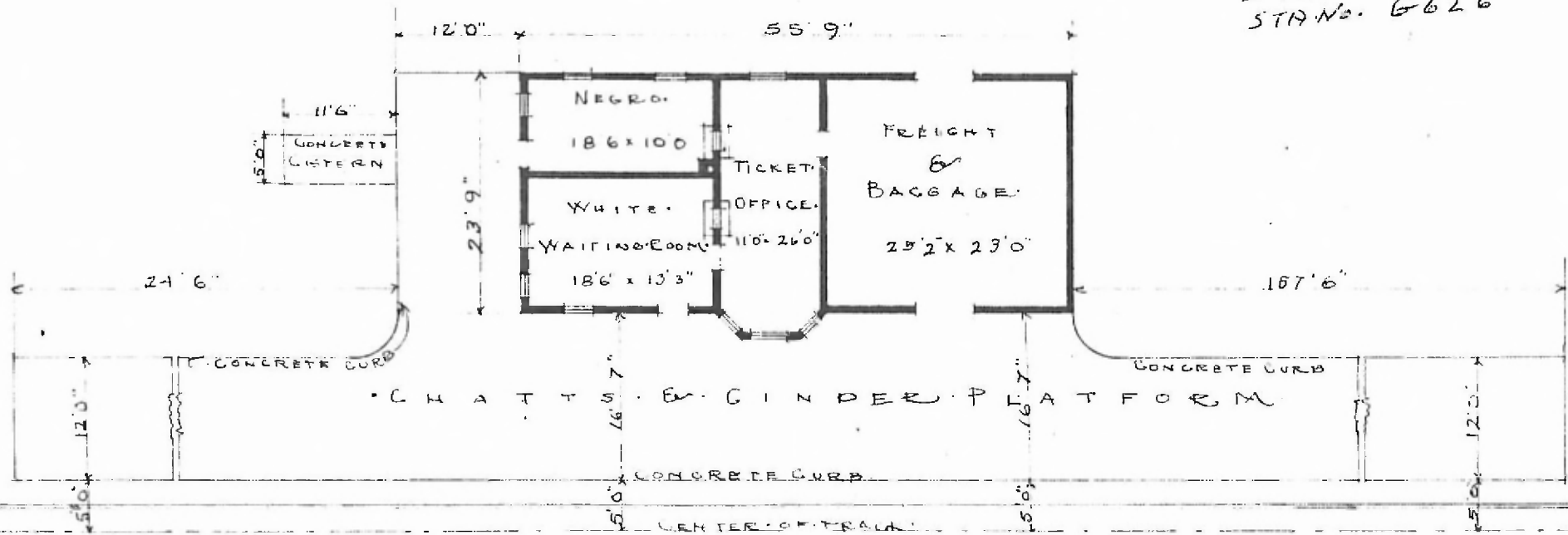

FLOOR PLAN -  
 SCALE 1/8"



PASSENGER STATION AT  
 FORT SILL OKLA.

OCTOBER 13 1916.