

46

DIV. SOUTHWESTERN
SUB-DIV. CHEROKEE
ST A. NO. G-388

ERECTED 1909.
 TYPE FRAME.
 FOUNDATION PILE HEADS.
 ROOF { TYPE HIP - SHINGLES.
 PITCH APPROX. $\frac{1}{3}$ PITCH.
 WALLS 2"x6" STUDS.
 HEATING STOVES.

FLOOR $\frac{3}{4}$ " x $3\frac{1}{2}$ " YELLOW PINE.
 FINISH { INSIDE BEADED CEILING.
 OUTSIDE LOVE SIDING.
 CEILING HEIGHTS 11'4" WAITING ROOM, T.O.; FREIGHT & BAGGAGE ROOM.
 LIGHTING OIL LAMPS.
 SANITARY FACILITIES OUTSIDE TOILETS.

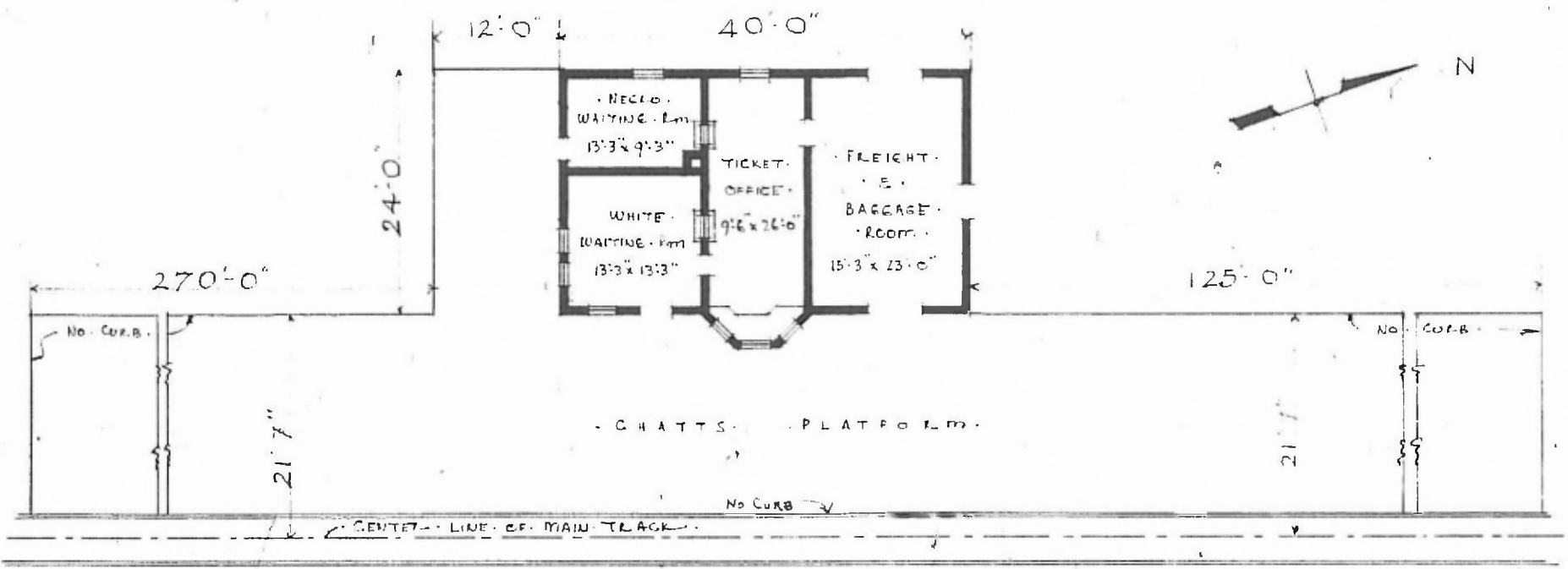

FLOOR PLAN
 SCALE $\frac{1}{16}$ " = 1'-0"

PASSENGER STATION AT
 FOYIL OKLA.

JULY 26 1916.